



Applications

Shackles are used in lifting and static systems as removable links to connect (steel) wire rope, chain and other fittings. Screw pin shackles are used mainly for non-permanent applications. Safety bolt shackles are used for long-term or permanent applications or where the load may slide on the pin causing rotation of the pin.

Chain or dee shackles are mainly used on one-leg systems whereas anchor or bow shackles are mainly used on multi-leg systems.

Range

Van Beest offers a wide range of bow and dee shackles, depending on the application on which the shackle is going to be used; the range stretches from Working Load Limit (WLL) 0.33 tons to 1500 tons. Therefore, our customers have a very extensive range to choose the shackle exactly suitable for the application. Most of the shackles are directly available from stock. Furthermore, shackles can be supplied to many standards such as the US Federal Specification RR-C-271, EN 13889, British Standard 3032, DIN 82101, DIN 82016 etc.

Polar shackles are for use in extreme climatic conditions with material properties guaranteed up to temperatures of -40°C, and furthermore we offer a wide range of general commercial shackles, which are not suitable for lifting but merely for fixing purposes.

Design

All Van Beest shackles have a specific design for a specific application. Examples are the "Super" shackles which are made out of grade 8 steel enabling the dimensions of the shackles to be minimized for use in limited space conditions, without loss of functionality or Working Load Limit.

Or sling shackles for use with large slings, to provide a better radius to the sling being used. Another example of functional design is the use of shackles where the pin has a square sunken hole so as not to obstruct the use of fishing nets. These are all examples of a highly functional design, to optimize the use of the Van Beest shackles in daily use.

Furthermore, shackles used for lifting applications are stamped with the following marks, to specify the quality and safety of use of the shackles:

- | | |
|--|---|
| - Working Load Limit | ■ i.e. WLL 25 T |
| - manufacturer's identification symbol | ■ i.e. GP, indicating Green Pin or Bs, indicating Van Beest |
| - traceability code | ■ i.e. HA pertaining to a particular batch |
| - steel grade | ■ i.e. 4, 6, 8 |
| - CE conformity code | ■ i.e. CE, Conformité Européen |

Van Beest Green Pin® shackles meet all relevant requirements of the Machinery Directive 2006/42/EC and all latest amendments.

CAD drawings

Green Pin® shackles are used in a wide variety of applications; from a simple lift to move an item from A to B in a workplace, to very complex lifting systems for offshore applications. In the latter case, engineers use computer programs like AutoCAD to develop a 2D or 3D specification of the entire system.

For standard products usually a CAD drawing library is used. The use of these kind of libraries saves considerable design time and costs. And of course it prevents mistakes that may occur whilst copying data from a product catalogue into the design program.

To help the engineers, Van Beest have made their shackle drawings available in various formats. These drawings can be integrated in almost every design program.

Currently there are drawings available for Green Pin® Standard, Polar, Super, Sling and Heavy Duty shackles. Product designs are available in various formats, like: DWG, IGES, PDF, SAT and STEP.

The drawings can be downloaded from our server. Please contact our sales department to receive the download instructions.

Finish

Shackles supplied by Van Beest can be either hot dipped galvanized, electro-galvanized, painted or self coloured, depending on the type of shackle and its application.

You can find the finish of each type of shackle in the product section further on.



Certification

Upon request at time of order, all load rated shackles can be supplied with any of the following documents or certificates:

- works certificate in accordance with EN 10204 - 2.1 or 2.2;
- material certificate in accordance with EN 10204 - 3.1;
- manufacturer test certificate;
- EC Declaration of Conformity in accordance with annex IIA of the machine directive 2006/42/EC;
- inspection certificate in accordance with EN 10204 - 3.2;
- proof load test certificate;
- certificate with the actual breaking load experienced on tested samples;
- test report of Magnetic Particle Inspection (M.P.I.);
- test report of Ultrasonic Inspection (U.S.).

The first four of the above mentioned certificates can be supplied at no extra charge. For all other certificates, additional costs will be charged.

The test certificates can be supplied surveyed by all official classification societies, such as Lloyd's, Det Norske Veritas, British Standards Bureau, American Bureau of Shipping, Germanischer Lloyd's or any other officially certified inspection body.

Green Pin® Standard Shackles and Green Pin® Polar Shackles are DNV type approved to certification Note 2.7-1, lifting sets for offshore containers.

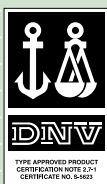

Instructions for use

Shackles should be inspected before use to ensure that:

- all markings are legible;
- the body and pin are both identifiable as being of the same size, type and make;
- the threads of the pin and the body are undamaged;
- never use a safety bolt type shackle without using a securing pin;
- the body and the pin are not distorted or unduly worn;
- the body and pin are free from nicks, gouges, cracks and corrosion;
- shackles may not be heat treated as this may affect their Working Load Limit;
- never modify, repair or reshape a shackle by welding, heating or bending as this will affect the Working Load Limit.

Assembly

Ensure that the pin is correctly screwed into the shackle eye, i.e. tighten hand-tight, then secure using a wrench or other suitable tool so that the collar of the pin is fully seated on the shackle eye. Ensure that the pin is of the correct length so that it penetrates the full depth of the screwed eye and allows the collar of the pin to seat on the surface of the shackle eye.

Incorrect seating of the pin may be due to a bent pin, too tight fitting thread or misalignment of the pin holes. Do not use the shackle under these circumstances. Never replace a shackle pin except with one of the same size, type and make as it may not be suitable for the loads imposed.

Select the correct type of shackle and its Working Load Limit for the particular application. Should extreme circumstances or shock loading be applicable, this must be well taken into account on selecting the correct shackle. Please note that commercial shackles are not to be used for lifting applications.

Make sure that the shackle is supporting the load correctly, i.e. along the axis of the shackle body centreline, avoid introduction of bending loads, unstable loads and do not apply overloads.

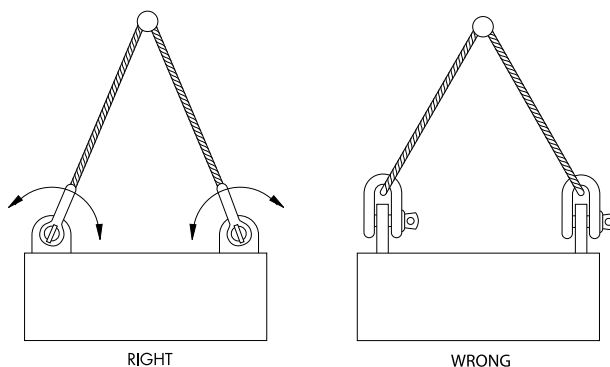

Side loads

Side loads should be avoided as well, as the products are not designed for this purpose. If side loads cannot be avoided, the following reduction factors must be taken into account:

Load angle	Reduction for side loading New Working Load Limit
0°	100% of original Working Load Limit
45°	70% of original Working Load Limit
90°	50% of original Working Load Limit

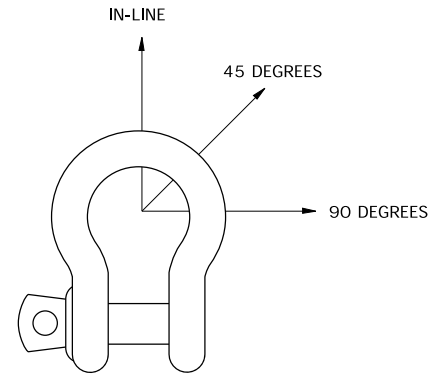

In-line loading is considered to be a load perpendicular to the pin and in the plane of the bow. Load angles in the table are the deviating angles from the in line loads.

When using shackles in connection with multi-leg slings, due consideration should be given to the effect of the angle between the legs of the sling. As the angle increases, so does the load in the sling leg and consequently in any shackle attached to that leg.

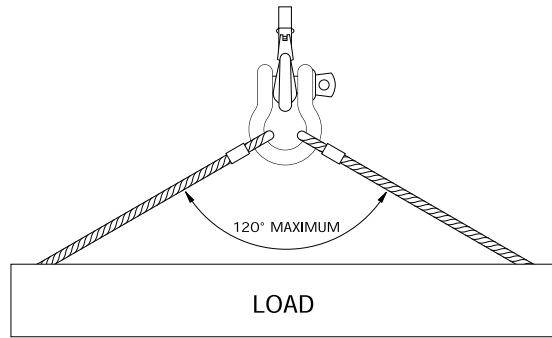

When a shackle is used to connect two slings to the hook of a lifting device, a bow type shackle must be assembled with the slings in the shackle body and the hook engaged with the shackle pin. The angle between the slings should not exceed 120°. If symmetrically loaded the shackle may be used to the full WLL.

To avoid eccentric loading of the shackle a loose spacer may be used on either end of the shackle pin. Do not reduce the width between the shackle jaws by welding washers or spacers to the inside faces of the eyes or by closing the jaws, as this will affect the properties of the shackle.

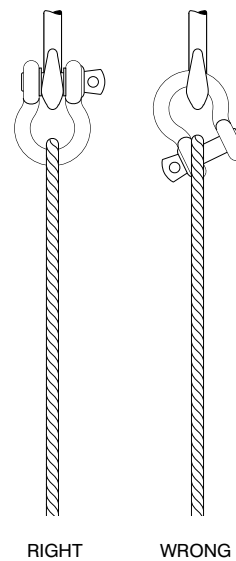

When a shackle is used to secure the top block of a set of wire rope blocks the load on this shackle is increased by the value of the hoisting effect.

Avoid applications where due to movement (e.g. of the load or the rope) the shackle pin can rotate and possibly be unscrewed. If such an application is necessary or when the shackle is to be left in place for a prolonged period or where maximum pin security is required, use a shackle with a safety bolt, nut and pin cotter pin.

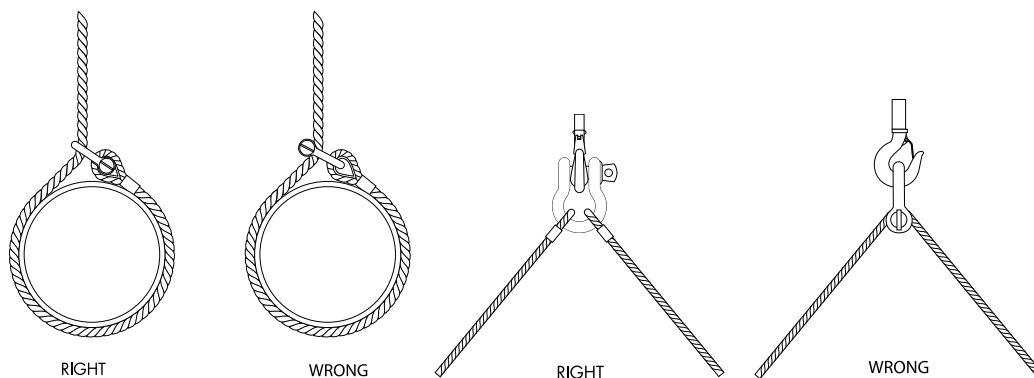

Shackles should not be immersed in acidic solutions or exposed to acid fumes or other chemicals that are potentially harmful for the shackle. Please be aware that these types of chemicals are used in certain production processes.

Point loading

Most of the time the load bearing component that is in connection with a shackle is of a rounded shape. Point loading of shackles is allowed but the minimum diameter of a rounded component should be equal or bigger than the bow size of the shackle being used.

Bigger diameters and/or flat parts (at shackle pin side) to increase contact area can be beneficial. Sharp edges should be avoided.

Temperature

If extreme temperature situations are applicable, the following load reduction must be taken into account:

Temperature	Reduction for elevated temperatures New Working Load Limit
up to 200°C	100% of original Working Load Limit
200 - 300°C	90% of original Working Load Limit
300 - 400°C	75% of original Working Load Limit
> 400°C	not allowed

The rating of shackles to EN 13889 assumes the absence of exceptionally hazardous conditions. Exceptionally hazardous conditions include offshore activities, the lifting of persons and the lifting of potentially dangerous loads such as molten metals, corrosive materials or fissile materials. In such cases a competent person should assess the degree of hazard and the safe working load should be reduced accordingly from the Working Load Limit.

Inspection

It is required that the shackles are regularly inspected and that the inspection should take place in accordance with the safety standards given in the country of use. This is required because the products in use may be affected by wear, misuse, overloading etc. with a consequence of deformation and alteration of the material structure. Inspection should take place at least every six months and even more frequently when the shackles are used in severe operating conditions.

1

2

3

4

5

6

7

8

9

10

11

12

13

14

15

16

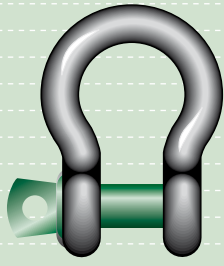

G-4161

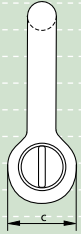
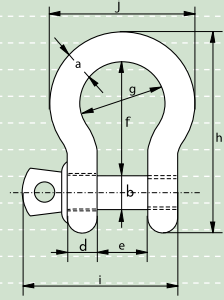

Green Pin® Standard Shackles

bow shackles with screw collar pin

- **Material** : bow and pin high tensile steel, Grade 6, quenched and tempered
- **Safety Factor** : MBL equals 6 x WLL
- **Standard** : EN 13889 and meets performance requirements of US Fed. Spec. RR-C-271 Type IVA Class 2, Grade A
- **Finish** : hot dipped galvanized
- **Temperature Range** : -20°C up to +200°C
- **Certification** : at no extra charges this product can be supplied with a works certificate, material certificate, manufacturer test certificate, EC Declaration of Conformity and all shackles starting from 2 t can be supplied with DNV 2.7-1 certificate.

working load limit	diameter bow	diameter pin	diameter eye	width eye	width inside	length inside	width bow	length	length bolt	width	weight each
t	a	b	c	d	e	f	g	h	i	j	kg
0.33	5	6	12	5	9.5	22	16	36	29.5	26	0.02
0.5	7	8	16.5	7	12	29	20	48.5	38	34	0.05
0.75	9	10	20	9	13.5	32	22	56	46.5	40	0.1
1	10	11	22.5	10	17	36.5	26	63.5	54	46	0.14
1.5	11	13	26.5	11	19	43	29	74	59.5	51	0.19
2	13.5	16	34	13	22	51	32	89	73	58	0.36
3.25	16	19	40	16	27	64	43	110	89	75	0.63
4.75	19	22	46	19	31	76	51	129	103	89	1.01
6.5	22	25	52	22	36	83	58	144	119	102	1.5
8.5	25	28	59	25	43	95	68	164	137	118	2.21
9.5	28	32	66	28	47	108	75	185	153	131	3.16
12	32	35	72	32	51	115	83	201	170	147	4.31
13.5	35	38	80	35	57	133	92	227	186	162	5.55
17	38	42	88	38	60	146	99	249	203	175	7.43
25	45	50	103	45	74	178	126	300	243	216	12.84
35	50	57	111	50	83	197	138	331	272	238	18.15
42.5	57	65	130	57	95	222	160	377	310	274	26.29
55	65	70	145	65	105	260	180	433	344	310	37.6

In inch

working load limit	diameter bow	diameter pin	diameter eye	width eye	width inside	length inside	width bow	length	length bolt	width	weight each
t	a	b	c	d	e	f	g	h	i	j	lbs
0.33	3/16	1/4	1/2	3/16	3/8	7/8	5/8	1 13/32	1 5/32	1 1/32	0.05
0.5	1/4	5/16	21/32	9/32	15/32	1 5/32	25/32	1 29/32	1 1/2	1 11/32	0.11
0.75	5/16	3/8	25/32	11/32	17/32	1 1/4	7/8	2 7/32	1 27/32	1 9/16	0.22
1	3/8	7/16	7/8	13/32	21/32	1 7/16	1 1/32	2 1/2	2 1/8	1 13/16	0.3
1.5	7/16	1/2	1 1/32	7/16	3/4	1 11/16	1 5/32	2 29/32	2 11/32	2	0.42
2	1/2	5/8	1 11/32	1/2	7/8	2	1 1/4	3 1/2	2 7/8	2 9/32	0.79
3.25	5/8	3/4	1 9/16	5/8	1 1/16	2 17/32	1 11/16	4 11/32	3 1/2	2 15/16	1.38
4.75	3/4	7/8	1 13/16	3/4	1 7/32	3	2	5 3/32	4 1/16	3 1/2	2.22
6.5	7/8	1	2 1/16	7/8	1 13/32	3 9/32	2 9/32	5 21/32	4 11/16	4 1/32	3.31
8.5	1	1 1/8	2 5/16	31/32	1 11/16	3 3/4	2 11/16	6 15/32	5 13/32	4 21/32	4.86
9.5	1 1/8	1 1/4	2 19/32	1 3/32	1 27/32	4 1/4	2 15/16	7 9/32	6 1/32	5 5/32	6.97
12	1 1/4	1 3/8	2 27/32	1 1/4	2	4 17/32	3 9/32	7 29/32	6 11/16	5 25/32	9.49
13.5	1 3/8	1 1/2	3 5/32	1 3/8	2 1/4	5 1/4	3 5/8	8 15/16	7 5/16	6 3/8	12.24
17	1 1/2	1 5/8	3 15/32	1 1/2	2 3/8	5 3/4	3 29/32	9 13/16	8	6 7/8	16.37
25	1 3/4	2	4 1/16	1 25/32	2 29/32	7	4 31/32	11 13/16	9 9/16	8 1/2	28.31
35	2	2 1/4	4 3/8	1 31/32	3 9/32	7 3/4	5 7/16	13 1/32	10 23/32	9 3/8	40.01
42.5	2 1/4	2 9/16	5 1/8	2 1/4	3 3/4	8 3/4	6 5/16	14 27/32	12 7/32	10 25/32	57.96
55	2 1/2	2 3/4	5 23/32	2 9/16	4 1/8	10 1/4	7 3/32	17 1/16	13 17/32	12 7/32	82.89



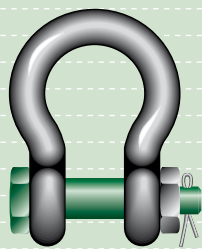

G-4163

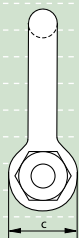
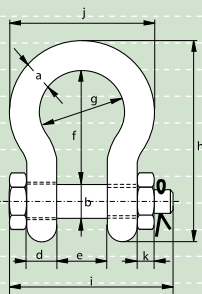

Green Pin® Standard Shackles

bow shackles with safety bolt

- **Material** : bow and pin high tensile steel, Grade 6, quenched and tempered
- **Safety Factor** : MBL equals 6 x WLL
- **Standard** : EN 13889 and
meets performance requirements of US Fed. Spec. RR-C-271 Type IVA Class 3, Grade A
- **Finish** : hot dipped galvanized
- **Temperature Range** : -20°C up to +200°C
- **Certification** : at no extra charges this product can be supplied with a works certificate, material certificate, manufacturer test certificate, EC Declaration of Conformity and all shackles starting from 2 t can be supplied with DNV 2.7-1 certificate.

working load limit	diameter bow	diameter pin	diameter eye	width eye	width inside	length inside	width bow	length bow	length bolt	width	thickness nut	weight each
t	a	b	c	d	e	f	g	h	i	j	k	kg
	mm	mm	mm	mm	mm	mm	mm	mm	mm	mm	mm	
0.5	7	8	16.5	7	12	29	20	48.5	42	34	4	0.06
0.75	9	10	20	9	13.5	32	22	56	50	40	5	0.11
1	10	11	22.5	10	17	36.5	26	63.5	60	46	8	0.16
1.5	11	13	26.5	11	19	43	29	74	67	51	11	0.22
2	13.5	16	34	13	22	51	32	89	82	58	13	0.42
3.25	16	19	40	16	27	64	43	110	98	75	17	0.74
4.75	19	22	46	19	31	76	51	129	114	89	19	1.18
6.5	22	25	52	22	36	83	58	144	130	102	22	1.77
8.5	25	28	59	25	43	95	68	164	150	118	25	2.58
9.5	28	32	66	28	47	108	75	185	166	131	27	3.66
12	32	35	72	32	51	115	83	201	178	147	30	4.91
13.5	35	38	80	35	57	133	92	227	197	162	33	6.54
17	38	42	88	38	60	146	99	249	202	175	39	8.19
25	45	50	103	45	74	178	126	300	249	216	23	14.22
35	50	57	111	50	83	197	138	331	269	238	26	19.85
42.5	57	65	130	57	95	222	160	377	301	274	29	28.33
55	65	70	145	65	105	260	180	433	330	310	32	39.59
85	75	83	162	73	127	329	190	527	380	340	39	62

In inch

working load limit	diameter bow	diameter pin	diameter eye	width eye	width inside	length inside	width bow	length bow	length bolt	width	thickness nut	weight each
t	a	b	c	d	e	f	g	h	i	j	k	lbs
	inch	inch	inch	inch	inch	inch	inch	inch	inch	inch	inch	
0.5	1/4	5/16	21/32	9/32	15/32	1 5/32	25/32	1 29/32	1 21/32	1 11/32	5/32	0.13
0.75	5/16	3/8	25/32	11/32	17/32	1 1/4	7/8	2 7/32	1 31/32	1 9/16	3/16	0.25
1	3/8	7/16	7/8	13/32	21/32	1 7/16	1 1/32	2 1/2	2 3/8	1 13/16	5/16	0.34
1.5	7/16	1/2	1 1/32	7/16	3/4	1 11/16	1 5/32	2 29/32	2 5/8	2	7/16	0.48
2	1/2	5/8	1 11/32	1/2	7/8	2	1 1/4	3 1/2	3 7/32	2 9/32	1/2	0.92
3.25	5/8	3/4	1 9/16	5/8	1 1/16	2 17/32	1 11/16	4 11/32	3 27/32	2 15/16	21/32	1.62
4.75	3/4	7/8	1 13/16	3/4	1 7/32	3	2	5 3/32	4 1/2	3 1/2	3/4	2.59
6.5	7/8	1	2 1/16	7/8	1 13/32	3 9/32	2 9/32	5 21/32	5 1/8	4 1/32	7/8	3.9
8.5	1	1 1/8	2 5/16	31/32	1 11/16	3 3/4	2 11/16	6 15/32	5 29/32	4 21/32	31/32	5.69
9.5	1 1/8	1 1/4	2 19/32	1 3/32	1 27/32	4 1/4	2 15/16	7 9/32	6 17/32	5 5/32	1 1/16	8.06
12	1 1/4	1 3/8	2 27/32	1 1/4	2	4 17/32	3 9/32	7 29/32	7	5 25/32	1 3/16	10.81
13.5	1 3/8	1 1/2	3 5/32	1 3/8	2 1/4	5 1/4	3 5/8	8 15/16	7 3/4	6 3/8	1 5/16	14.42
17	1 1/2	1 5/8	3 15/32	1 1/2	2 3/8	5 3/4	3 29/32	9 13/16	7 15/16	6 7/8	3/4	18.06
25	1 3/4	2	4 1/16	1 25/32	2 29/32	7	4 31/32	11 13/16	9 13/16	8 1/2	29/32	31.34
35	2	2 1/4	4 3/8	1 31/32	3 9/32	7 3/4	5 7/16	13 1/32	10 19/32	9 3/8	1 1/32	43.77
42.5	2 1/4	2 9/16	5 1/8	2 1/4	3 3/4	8 3/4	6 5/16	14 27/32	11 27/32	10 23/32	1 5/32	62.46
55	2 1/2	2 3/4	5 23/32	2 9/16	4 1/8	10 1/4	7 3/32	17 1/16	13	12 7/32	1 1/4	87.27
85	3	3 1/4	6 3/8	2 7/8	5	12 15/16	7 15/32	20 3/4	14 31/32	13 3/8	1 17/32	136.69



1

2

3

4

5

6

7

8

9

10

11

12

13

14

15

16

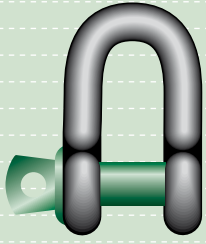

G-4151

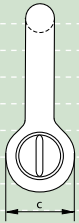
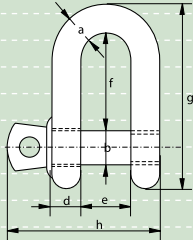

Green Pin® Standard Shackles

dee shackles with screw collar pin

- **Material** : bow and pin high tensile steel, Grade 6, quenched and tempered
- **Safety Factor** : MBL equals 6 x WLL
- **Standard** : EN 13889 and meets performance requirements of US Fed. Spec. RR-C-271 Type IVB Class 2, Grade A
- **Finish** : hot dipped galvanized
- **Temperature Range** : -20 °C up to +200 °C
- **Certification** : at no extra charges this product can be supplied with a works certificate, material certificate, manufacturer test certificate, EC Declaration of Conformity and all shackles starting from 2 t can be supplied with DNV 2.7-1 certificate.

working load limit	diameter bow	diameter pin	diameter eye	width eye	width inside	length inside	length	length bolt	weight each
t	a	b	c	d	e	f	g	h	kg
0.33	5	6	12	5	9.5	19	33	29.5	0.02
0.5	7	8	16.5	7	12	22	41.5	38	0.05
0.75	9	10	20	9	13.5	26	50	46.5	0.09
1	10	11	22.5	10	17	32	59	54	0.14
1.5	11	13	26.5	11	19	37	68	59.5	0.19
2	13.5	16	34	13	22	43	81	73	0.32
3.25	16	19	40	16	27	51	97	89	0.54
4.75	19	22	46	19	31	59	112	103	0.87
6.5	22	25	52	22	36	73	134	119	1.34
8.5	25	28	59	25	43	85	154	137	2.08
9.5	28	32	66	28	47	90	167	153	2.77
12	32	35	72	32	51	94	180	170	3.72
13.5	35	38	80	35	57	115	209	186	5.14
17	38	42	88	38	60	127	230	203	6.85
25	45	50	103	45	74	149	271	243	11.45
35	50	57	111	50	83	171	305	272	16.86
42.5	57	65	130	57	95	190	345	310	24.61
55	65	70	145	65	105	203	376	344	32.65

In inch

working load limit	diameter bow	diameter pin	diameter eye	width eye	width inside	length inside	length	length bolt	weight each
t	a	b	c	d	e	f	g	h	lbs
0.33	3/16	1/4	15/32	3/16	3/8	3/4	1 5/16	1 5/32	0.04
0.5	1/4	5/16	21/32	9/32	15/32	7/8	1 5/8	1 1/2	0.11
0.75	5/16	3/8	25/32	11/32	17/32	1 1/32	1 31/32	1 27/32	0.2
1	3/8	7/16	7/8	13/32	21/32	1 1/4	2 5/16	2 1/8	0.3
1.5	7/16	1/2	1 1/32	7/16	3/4	1 15/32	2 11/16	2 11/32	0.42
2	1/2	5/8	1 11/32	1/2	7/8	1 11/16	3 3/16	2 7/8	0.7
3.25	5/8	3/4	1 9/16	5/8	1 1/16	2	3 13/16	3 1/2	1.19
4.75	3/4	7/8	1 13/16	3/4	1 7/32	2 5/16	4 12/32	4 1/16	1.92
6.5	7/8	1	2 1/16	7/8	1 13/32	2 7/8	5 9/32	4 11/16	2.95
8.5	1	1 1/8	2 5/16	31/32	1 11/16	3 11/32	6 1/16	5 13/32	4.59
9.5	1 1/8	1 1/4	2 19/32	1 3/32	1 27/32	3 17/32	6 9/16	6 1/32	6.1
12	1 1/4	1 3/8	2 27/32	1 1/4	2	3 11/16	7 3/32	6 11/16	8.2
13.5	1 3/8	1 1/2	3 5/32	1 3/8	2 1/4	4 17/32	8 7/32	7 5/16	11.33
17	1 1/2	1 5/8	3 15/32	1 1/2	2 3/8	5	9 1/16	8	15.1
25	1 3/4	2	4 1/16	1 25/32	2 29/32	5 7/8	10 21/32	9 9/16	25.23
35	2	2 1/4	4 3/8	1 31/32	3 9/32	6 23/32	12	10 23/32	37.17
42.5	2 1/4	2 9/16	5 1/8	2 1/4	3 3/4	7 15/32	13 19/32	12 7/32	54.26
55	2 1/2	2 3/4	5 23/32	2 9/16	4 1/8	8	14 13/16	13 17/32	71.98



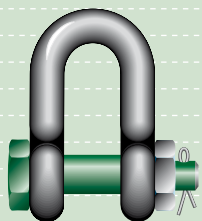

G-4153

Green Pin® Standard Shackles

dee shackles with safety bolt

- **Material** : bow and pin high tensile steel, Grade 6, quenched and tempered
- **Safety Factor** : MBL equals 6 x WLL
- **Standard** : EN 13889 and
meets performance requirements of US Fed. Spec. RR-C-271 Type IVB Class 3, Grade A
- **Finish** : hot dipped galvanized
- **Temperature Range** : -20 °C up to +200 °C
- **Certification** : at no extra charges this product can be supplied with a works certificate, material certificate, manufacturer test certificate, EC Declaration of Conformity and all shackles starting from 2 t can be supplied with DNV 2.7-1 certificate.

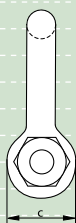
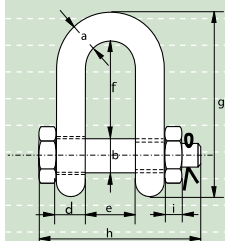

working load limit	diameter bow	diameter pin	diameter eye	width eye	width inside	length inside	length	length bolt	thickness nut	weight each
t	a	b	c	d	e	f	g	h	i	kg
2	13.5	16	34	13	22	43	81	82	13	0.39
3.25	16	19	40	16	27	51	97	98	17	0.67
4.75	19	22	46	19	31	59	112	114	19	1.08
6.5	22	25	52	22	36	73	134	130	22	1.66
8.5	25	28	59	25	43	85	154	150	25	2.46
9.5	28	32	66	28	47	90	167	166	27	3.4
12	32	35	72	32	51	94	180	178	30	4.51
13.5	35	38	80	35	57	115	209	197	33	6.1
17	38	42	88	38	60	127	230	202	19	7.63
25	45	50	103	45	74	149	271	249	23	13.25
35	50	57	111	50	83	171	305	269	26	18.53
42.5	57	65	130	57	95	190	345	301	29	25.94
55	65	70	145	65	105	203	376	330	32	35.33
85	75	83	162	73	127	229	427	380	39	52.97

In inch

working load limit	diameter bow	diameter pin	diameter eye	width eye	width inside	length inside	length	length bolt	thickness nut	weight each
t	a	b	c	d	e	f	g	h	i	lbs
2	1/2	5/8	1 11/32	1/2	7/8	1 11/16	3 3/16	3 7/32	1/2	0.85
3.25	5/8	3/4	1 9/16	5/8	1 1/16	2	3 13/16	3 27/32	21/32	1.48
4.75	3/4	7/8	1 13/16	3/4	1 7/32	2 5/16	4 13/32	4 1/2	3/4	2.39
6.5	7/8	1	2 1/16	7/8	1 13/32	2 7/8	5 9/32	5 1/8	7/8	3.66
8.5	1	1 1/8	2 5/16	31/32	1 11/16	3 11/32	6 1/16	5 29/32	31/32	5.42
9.5	1 1/8	1 1/4	2 19/32	1 3/32	1 27/32	3 17/32	6 9/16	6 17/32	1 1/16	7.5
12	1 1/4	1 3/8	2 27/32	1 1/4	2	3 11/16	7 3/32	7	1 3/16	9.95
13.5	1 3/8	1 1/2	3 5/32	1 3/8	2 1/4	4 17/32	8 7/32	7 3/4	1 5/16	13.45
17	1 1/2	1 5/8	3 15/32	1 1/2	2 3/8	5	9 1/16	7 15/16	3/4	16.82
25	1 3/4	2	4 1/16	1 25/32	2 29/32	5 7/8	10 21/32	9 13/16	29/32	29.21
35	2	2 1/4	4 3/8	1 31/32	3 9/32	6 23/32	12	10 19/32	1 1/32	40.86
42.5	2 1/4	2 9/16	5 1/8	2 1/4	3 3/4	7 15/32	13 19/32	11 27/32	1 5/32	57.19
55	2 1/2	2 3/4	5 23/32	2 9/16	4 1/8	8	14 13/16	13	1 1/4	77.89
85	3	3 1/4	6 3/8	2 7/8	5	9 1/32	16 13/16	14 31/32	1 17/32	116.77

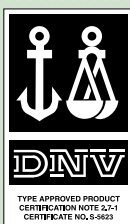

1

2

3

4

5

6

7

8

9

10

11

12

13

14

15

16

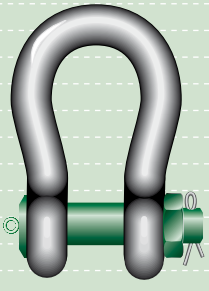

P-6036

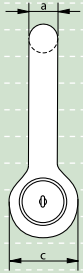
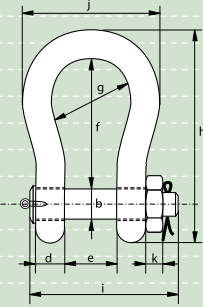

Green Pin® Heavy Duty Shackles

bow shackles with safety bolt

- **Material** : bow and pin alloy steel, Grade 8 quenched and tempered
- **Safety Factor** : MBL equals 5 x WLL
- **Finish** : shackle bow painted silver, pin painted green (120 tons shackle is hot dipped galvanized)
- **Certification** : at no extra charges this product can be supplied with a works certificate, material certificate, manufacturer test certificate, EC Declaration of Conformity and all shackles starting from 150 tons are supplied with a Lloyd's Register of Shipping Certificate on proof load

working load limit	diameter bow	diameter pin	diameter eye	width eye	width inside	length inside	width bow	length bow	length bolt	width bolt	thickness nut	weight each
t	a mm	b mm	c mm	d mm	e mm	f mm	g mm	h mm	i mm	j mm	k mm	kg
120	95	95	208	91	147	400	238	647	440	428	50	110
150	105	108	238	102	169	410	275	688	490	485	60	160
200	120	130	279	113	179	513	290	838	520	530	60	235
250	130	140	299	118	205	554	305	904	560	565	65	285
300	140	150	325	123	205	618	305	996	575	585	70	340
400	170	175	376	164	231	668	325	1114	690	665	70	560
500	180	185	398	164	256	718	350	1190	720	710	70	685
600	200	205	444	189	282	718	375	1243	810	775	70	880
700	210	215	454	204	308	718	400	1263	870	820	70	980
800	210	220	464	204	308	718	400	1270	870	820	70	1100
900	220	230	485	215	328	718	420	1296	920	860	70	1280
1000	240	240	515	215	349	718	420	1336	940	900	70	1460
1250	260	270	585	230	369	768	450	1456	1025	970	70	1990
1500	280	290	625	230	369	818	450	1556	1025	1010	70	2400

In inch

working load limit	diameter bow	diameter pin	diameter eye	width eye	width inside	length inside	width bow	length bow	length bolt	width bolt	thickness nut	weight each
t	a inch	b inch	c inch	d inch	e inch	f inch	g inch	h inch	i inch	j inch	k inch	lbs
120	3 3/4	3 3/4	8 3/16	3 19/32	5 25/32	15 3/4	9 3/8	25 15/32	17 5/16	16 27/32	1 31/32	243
150	4 1/8	4 1/4	9 3/8	4 1/32	6 21/32	16 5/32	10 13/16	27 3/32	19 9/32	19 3/32	2 3/8	353
200	4 23/32	5 1/8	10 31/32	4 7/16	7 1/16	20 3/16	11 13/32	33	20 15/32	20 7/8	2 3/8	518
250	5 1/8	5 1/2	11 25/32	4 21/32	8 1/16	21 13/16	12	35 19/32	22 1/16	22 1/4	2 9/16	628
300	5 1/2	5 29/32	12 25/32	4 27/32	8 1/16	24 11/32	12	39 7/32	22 5/8	23 1/32	2 3/4	750
400	6 11/16	6 7/8	14 13/16	6 15/32	9 3/32	26 5/16	12 25/32	43 27/32	27 5/32	26 3/16	2 3/4	1235
500	7 3/32	7 9/32	15 21/32	6 15/32	10 3/32	28 9/32	13 25/32	46 27/32	28 11/32	27 15/16	2 3/4	1510
600	7 7/8	8 1/16	17 15/32	7 7/16	11 3/32	28 9/32	14 3/4	48 15/16	31 7/8	30 1/2	2 3/4	1940
700	8 9/32	8 15/32	17 7/8	8 1/32	12 1/8	28 9/32	15 3/4	49 23/32	34 1/4	32 9/32	2 3/4	2161
800	8 9/32	8 21/32	18 9/32	8 1/32	12 1/8	28 9/32	15 3/4	50	34 1/4	32 9/32	2 3/4	2425
900	8 21/32	9 1/16	19 3/32	8 15/32	12 29/32	28 9/32	16 17/32	51 1/32	36 7/32	33 27/32	2 3/4	2822
1000	9 7/16	9 7/16	20 9/32	8 15/32	13 3/4	28 9/32	16 17/32	52 19/32	37	35 7/16	2 3/4	3219
1250	10 1/4	10 5/8	23 1/32	9 1/16	14 17/32	30 1/4	17 23/32	57 5/16	40 11/32	38 3/16	2 3/4	4387
1500	11 1/32	11 13/32	24 19/32	9 1/16	14 17/32	32 7/32	17 23/32	61 1/4	40 11/32	39 3/4	2 3/4	5291

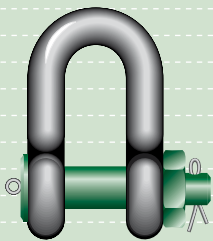

Green Pin® Heavy Duty Shackles

dee shackles with safety bolt

- **Material** : bow and pin alloy steel, Grade 8, quenched and tempered
- **Safety Factor** : MBL equals 5 x WLL
- **Finish** : hot dipped galvanized
- **Certification** : at no extra charges this product can be supplied with a works certificate, material certificate, manufacturer test certificate and/or EC Declaration of Conformity

G-6038

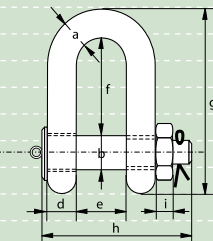

working load limit	diameter bow	diameter pin	diameter eye	width eye	width inside	length inside	length	length bolt	thickness nut	weight each
t	a	b	c	d	e	f	g	h	i	kg
120	95	95	208	95	147	274	521	440	50	110

In inch

working load limit	diameter bow	diameter pin	diameter eye	width eye	width inside	length inside	length	length bolt	thickness nut	weight each
t	a	b	c	d	e	f	g	h	inch	lbs
120	3 ³ / ₄	3 ³ / ₄	8 ³ / ₁₆	3 ³ / ₄	5 ²⁵ / ₃₂	10 ²⁵ / ₃₂	20 ¹ / ₂	17 ⁵ / ₁₆	1 ³¹ / ₃₂	243

1

2

3

4

5

6

7

8

9

10

11

12

13

14

15

16

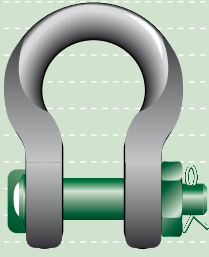

P-6033

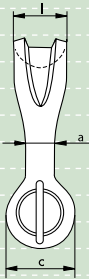
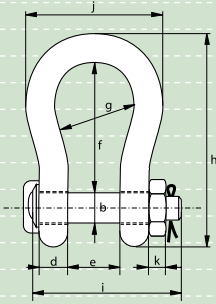

Green Pin® Sling Shackles

bow shackles with safety bolt

- **Material** : bow and pin alloy steel, Grade 8, quenched and tempered
- **Safety Factor** : MBL equals 5 x WLL
- **Finish** : shackle bow painted silver, pin painted green
- **Temperature Range** : -20 °C up to +200 °C
- **Certification** : at no extra charges this product can be supplied with a works certificate, material certificate, manufacturer test certificate, EC declaration of Conformity and all shackles from 75 t are supplied with a Lloyd's Register of Shipping Certificate on proof load. An MPI and/or US inspection certificate can be supplied on request

working load limit	diameter body	diameter pin	diameter eye	width eye	width inside	length inside	width bow	length	length bolt	width	thickness nut	bearing surface	weight each
t	a	b	c	d	e	f	g	h	i	j	k	l	kg
18	35	35	69	30	52	147	102	239	165	180	29	64	7
30	40	42	90	35	69	165	126	279	207	200	34	79	13
40	55	51	109	45	84	199	140	331	252	235	38	97	21
55	60	57	115	55	90	240	160	389	294	270	45	100	30
75	68	70	125	54	110	290	185	473	327	317	54	120	48
125	85	80	154	85	137	366	220	583	426	390	64	150	92
150	94	95	179	89	147	391	253	645	435	434	50	170	140
200	110	105	199	100	158	481	280	759	470	482	50	205	205
250	126	120	227	110	179	542	300	859	519	530	60	240	264
300	135	134	245	122	195	601	350	947	575	620	70	265	360
400	160	160	293	145	231	576	370	985	675	690	80	320	580
500	170	180	328	160	263	681	450	1131	748	790	90	339	780
600	190	200	348	170	289	741	490	1234	809	865	100	370	980
700	200	215	392	190	315	751	540	1284	879	901	100	400	1360
800	218	230	420	200	342	851	554	1426	942	947	110	420	1430
900	242	255	466	220	368	851	580	1488	1023	1023	120	440	1650
1000	260	270	490	240	399	851	614	1532	1103	1107	120	460	2120
1250	285	300	510	260	452	931	650	1666	1227	1182	150	530	3700
1500	285	320	550	280	483	950	680	1710	1300	1253	150	560	4000

In inch

working load limit	diameter body	diameter pin	diameter eye	width eye	width inside	length inside	width bow	length	length bolt	width	thickness nut	bearing surface	weight each
t	a	b	c	d	e	f	g	h	i	j	k	l	lbs
18	1 3/8	1 3/8	2 23/32	1 3/16	2 1/16	5 25/32	4 1/32	9 13/32	6 1/2	7 3/8	1 5/32	2 17/32	18
30	1 9/16	1 21/32	3 17/32	1 3/8	2 23/32	6 1/2	4 31/32	10 31/32	8 5/32	7 7/8	1 11/32	3 1/8	29
40	2 5/32	2	4 9/32	1 25/32	3 5/16	7 27/32	5 1/2	13 1/32	9 29/32	9 1/4	1 1/2	3 13/16	46
55	2 3/8	2 1/4	4 17/32	2 5/32	3 17/32	9 7/16	6 5/16	15 5/16	11 9/16	10 5/8	1 25/32	3 15/16	66
75	2 11/16	2 3/4	4 29/32	2 1/8	4 11/32	11 13/32	7 9/32	18 5/8	12 7/8	12 15/32	2 1/8	4 23/32	106
125	3 11/32	3 5/32	6 1/16	3 11/32	5 13/32	14 13/32	8 21/32	22 15/16	16 25/32	15 11/32	2 17/32	5 29/32	203
150	3 11/16	3 3/4	7 1/16	3 1/2	5 25/32	15 13/32	9 31/32	25 13/32	17 1/8	17 3/8	1 31/32	6 11/16	309
200	4 11/32	4 1/8	7 27/32	3 15/16	6 7/32	18 15/16	11 1/32	29 7/8	18 1/2	18 31/32	1 31/32	8 1/16	452
250	4 31/32	4 23/32	8 15/16	4 11/32	7 1/16	21 11/32	11 13/16	33 13/16	20 7/16	20 7/8	2 3/8	9 7/16	582
300	5 5/16	5 9/32	9 21/32	4 13/16	7 11/16	23 21/32	13 25/32	37 9/32	22 5/8	24 13/32	2 3/4	10 7/16	794
400	6 5/16	6 5/16	11 17/32	5 23/32	9 3/32	22 11/16	14 9/16	38 25/32	26 9/16	27 5/32	3 5/32	12 19/32	1279
500	6 11/16	7 3/32	12 29/32	6 5/16	10 11/32	26 13/16	17 23/32	44 17/32	29 7/16	31 3/32	3 17/32	13 11/32	1720
600	7 15/32	7 7/8	13 11/16	6 11/16	11 3/8	29 3/16	19 9/32	48 19/32	31 27/32	34 1/16	3 15/16	14 9/16	2161
700	7 7/8	8 15/32	15 7/16	7 15/32	12 13/32	29 9/16	21 1/4	50 9/16	34 19/32	35 15/32	3 15/16	15 3/4	2998
800	8 19/32	9 1/16	16 17/32	7 7/8	13 15/32	33 1/2	21 13/16	56 5/32	37 3/32	37 9/32	4 11/32	16 17/32	3153
900	9 17/32	10 1/32	18 11/32	8 21/32	14 1/2	33 1/2	22 27/32	58 19/32	40 9/32	40 9/32	4 23/32	17 5/16	3638
1000	10 1/4	10 5/8	19 9/32	9 7/16	15 23/32	33 1/2	24 3/16	60 5/16	43 7/16	43 19/32	4 23/32	18 1/8	4674
1250	11 7/32	11 13/16	20 3/32	10 1/4	17 25/32	36 21/32	25 19/32	65 19/32	48 5/16	46 17/32	5 29/32	20 7/8	8157
1500	11 7/32	12 19/32	21 21/32	11 1/32	19 1/32	37 13/32	26 25/32	67 5/16	51 3/16	49 11/32	5 29/32	22 1/16	8818

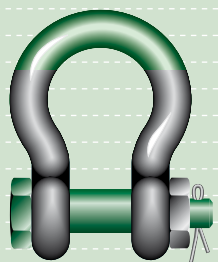

G-5263

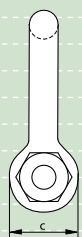
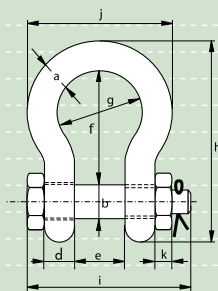

Green Pin® Super Shackles

bow shackles with safety bolt

- **Material** : bow and pin alloy steel, Grade 8, quenched and tempered
- **Safety Factor** : MBL equals 5 x WLL
- **Standard** : meets performance requirements of US Fed. Spec. RR-C-271 Type IVA Class 3, Grade B
- **Finish** : hot dipped galvanized (175 ton shackle is painted)
- **Temperature Range** : -20 °C up to +200 °C
- **Certification** : at no extra charges this product can be supplied with a works certificate, material certificate, manufacturer test certificate, EC Declaration of Conformity and all shackles starting from 150 tons are supplied with a Lloyd's Register of Shipping Certificate on proof load

working load limit	diameter bow	diameter pin	diameter eye	width eye	width inside	length inside	width bow	length	length bolt	width	thickness nut	weight each
t	a	b	c	d	e	f	g	h	i	j	k	kg
	mm	mm	mm	mm	mm	mm	mm	mm	mm	mm	mm	
3.3	13.5	16	34	13	22	51	32	89	82	58	13	0.44
5	16	19	40	16	27	64	43	110	98	75	17	0.79
7	19	22	46	19	31	76	51	129	114	89	19	1.26
9.5	22	25	52	22	36	83	58	144	130	102	22	1.88
12.5	25	28	59	25	43	95	68	164	150	118	25	2.78
15	28	32	66	28	47	108	75	185	166	131	27	3.87
18	32	35	72	32	51	115	83	201	178	147	30	5.26
21	35	38	80	35	57	133	92	227	197	162	33	6.94
30	38	42	88	38	60	146	99	249	202	175	19	8.79
40	45	50	103	45	74	178	126	300	249	216	23	15
55	57	57	117	57	83	197	138	341	286	252	26	22
85	70	70	143	70	105	260	180	437	344	320	32	42
120	83	83	162	83	127	329	190	535	403	356	40	70
150*	95	95	208	91	147	400	238	647	511	428	50	112
175*	105	108	238	102	169	410	275	688	561	485	60	160

* = round headed bolt

In inch

working load limit	diameter bow	diameter pin	diameter eye	width eye	width inside	length inside	width bow	length	length bolt	width	thickness nut	weight each
t	a	b	c	d	e	f	g	h	i	j	k	lbs
	inch	inch	inch	inch	inch	inch	inch	inch	inch	inch	inch	
3.3	1/2	5/8	1 11/32	1/2	7/8	2	1 1/4	3 1/2	3 7/32	2 9/32	1/2	0.97
5	5/8	3/4	1 9/16	5/8	1 1/16	2 17/32	1 11/16	4 11/32	3 27/32	2 15/16	2 1/32	1.74
7	3/4	7/8	1 13/16	3/4	1 7/32	3	2	5 3/32	4 1/2	3 1/2	3/4	2.78
9.5	7/8	1	2 1/16	7/8	1 13/32	3 9/32	2 9/32	5 21/32	5 1/8	4 1/32	7/8	4.14
12.5	1	1 1/8	2 5/16	31/32	1 11/16	3 3/4	2 11/16	6 15/32	5 29/32	4 21/32	31/32	6.13
15	1 1/8	1 1/4	2 19/32	1 3/32	1 27/32	4 1/4	2 15/16	7 9/32	6 17/32	5 5/32	1 1/16	8.53
18	1 1/4	1 3/8	2 27/32	1 1/4	2	4 17/32	3 9/32	7 29/32	7	5 25/32	1 3/16	11.6
21	1 3/8	1 1/2	3 5/32	1 3/8	2 1/4	5 1/4	3 5/8	8 15/16	7 3/4	6 3/8	1 5/16	15.3
30	1 1/2	1 5/8	3 15/32	1 1/2	2 3/8	5 3/4	3 29/32	9 13/16	7 15/16	6 7/8	3/4	19.38
40	1 3/4	2	4 1/16	1 25/32	2 29/32	7	4 31/32	11 13/16	9 13/16	8 1/2	29/32	33.07
55	2	2 1/4	4 19/32	2 1/4	3 9/32	7 3/4	5 7/16	13 7/16	11 1/4	9 29/32	1 1/32	48.50
85	2 1/2	2 3/4	5 5/8	2 3/4	4 1/8	10 1/4	7 3/32	17 7/32	13 17/32	12 19/32	1 1/4	92.59
120	3	3 1/4	6 3/8	3 9/32	5	12 15/16	7 15/32	21 1/16	15 7/8	14 1/32	1 9/16	154.32
150*	3 3/4	3 3/4	8 3/16	3 19/32	5 25/32	15 3/4	9 3/8	25 15/32	20 1/8	16 27/32	1 31/32	246.92
175*	4	4 1/4	9 3/8	4 1/32	6 21/32	16 5/32	10 13/16	27 3/32	22 3/32	19 3/32	2 3/8	352.74

* = round headed bolt

1

2

3

4

5

6

7

8

9

10

11

12

13

14

15

16

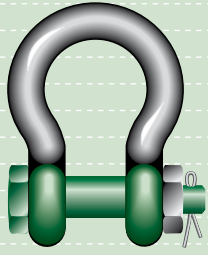

G-5163

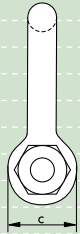
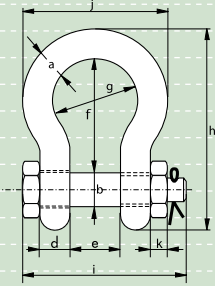

Green Pin® Polar Shackles

bow shackles with safety bolt, for use under extreme climatic conditions

- **Material** : bow and pin alloy steel, Grade 8, quenched and tempered
- **Safety Factor** : MBL equals 8 x WLL
- **Standard** : EN 13889 and
meets performance requirements of US Fed. Spec. RR-C-271 Type IVA Class 3, Grade B
- **Finish** : hot dipped galvanized
- **Temperature Range** : -40 °C up to +200 °C
- **Certification** : at no extra charges this product can be supplied and/or a works certificate, material certificate, manufacturer test certificate, EC Declaration of Conformity and/or DNV 2.7-1 certificate.
- **Note** : for shackles with WLL 55 and 85 tons the MBL equals 6 x WLL

working load limit	diameter bow	diameter pin	diameter eye	width eye	width inside	length inside	width bow	length	length bolt	width	thickness nut	weight each
t	a	b	c	d	e	f	g	h	i	j	k	kg
	mm	mm	mm	mm	mm	mm	mm	mm	mm	mm	mm	
2	13.5	16	34	13	22	51	32	89	82	58	13	0.42
3.25	16	19	40	16	27	64	43	110	98	75	17	0.74
4.75	19	22	46	19	31	76	51	129	114	89	19	1.18
6.5	22	25	52	22	36	83	58	144	130	102	22	1.77
8.5	25	28	59	25	43	95	68	164	150	118	25	2.58
9.5	28	32	66	28	47	108	75	185	166	131	27	3.66
12	32	35	72	32	51	115	83	201	178	147	30	4.91
13.5	35	38	80	35	57	133	92	227	197	162	33	6.54
17	38	42	88	38	60	146	99	249	202	175	19	8.19
25	45	50	103	45	74	178	126	300	249	216	23	14.22
35	50	57	116	50	83	197	138	334	269	238	26	19.85
42.5	57	65	130	57	95	222	160	377	301	274	29	28.33
55	65	70	145	65	105	260	180	433	330	310	32	39.59
85	75	83	162	73	127	329	190	527	380	340	40	62

In inch

working load limit	diameter bow	diameter pin	diameter eye	width eye	width inside	length inside	width bow	length	length bolt	width	thickness nut	weight each
t	a	b	c	d	e	f	g	h	i	j	k	lbs
	inch	inch	inch	inch	inch	inch	inch	inch	inch	inch	inch	
2	1/2	5/8	1 11/32	1/2	7/8	2	1 1/4	3 1/2	3 7/32	2 9/32	1/2	0.92
3.25	5/8	3/4	1 9/16	5/8	1 1/16	2 17/32	1 11/16	4 11/32	3 27/32	2 15/16	21/32	1.62
4.75	3/4	7/8	1 13/16	3/4	1 7/32	3	2	5 3/32	4 1/2	3 1/2	3/4	2.59
6.5	7/8	1	2 1/16	7/8	1 13/32	3 9/32	2 9/32	5 21/32	5 1/8	4 1/32	7/8	3.9
8.5	1	1 1/8	2 5/16	31/32	1 11/16	3 3/4	2 11/16	6 15/32	5 29/32	4 21/32	31/32	5.69
9.5	1 1/8	1 1/4	2 19/32	1 3/32	1 27/32	4 1/4	2 15/16	7 9/32	6 17/32	5 5/32	1 1/16	8.06
12	1 1/4	1 3/8	2 27/32	1 1/4	2	4 17/32	3 9/32	7 29/32	7	5 29/32	1 3/16	10.81
13.5	1 3/8	1 1/2	3 5/32	1 3/8	2 1/4	5 1/4	3 5/8	8 15/16	7 3/4	6 3/8	1 5/16	14.42
17	1 1/2	1 5/8	3 15/32	1 1/2	2 3/8	5 3/4	3 29/32	9 13/16	7 15/16	6 7/8	3/4	18.06
25	1 3/4	2	4 1/16	1 25/32	2 29/32	7	4 31/32	11 13/16	9 13/16	8 1/2	29/32	31.34
35	2	2 1/4	4 9/16	1 31/32	3 9/32	7 3/4	5 7/16	13 5/32	10 19/32	9 3/8	1 1/32	43.77
42.5	2 1/4	2 9/16	5 1/8	2 1/4	3 3/4	8 3/4	6 5/16	14 27/32	11 27/32	10 25/32	1 5/32	62.46
55	2 1/2	2 3/4	5 23/32	2 9/16	4 1/8	10 1/4	7 3/32	17 1/16	13	12 7/32	1 1/4	87.27
85	3	3 1/4	6 3/8	2 7/8	5	12 15/16	7 15/32	20 3/4	14 31/32	13 3/8	1 9/16	136.69

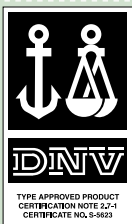

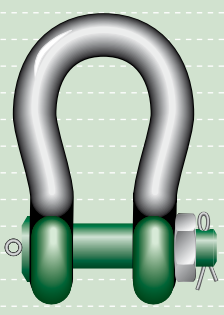

P-6031

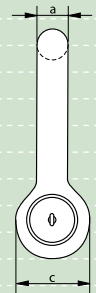
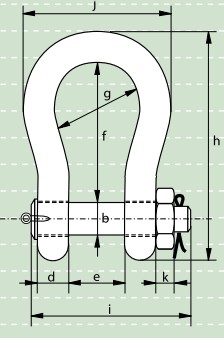

Green Pin® Heavy Duty Polar Shackles

bow shackles with safety bolt, for use under extreme climatic conditions

- **Material** : bow and pin alloy steel, Grade 8, quenched and tempered
- **Safety Factor** : MBL equals 5 x WLL
- **Finish** : shackle bow painted silver, pin painted green (120 tons shackle is hot dipped galvanized)
- **Temperature Range** : -40 °C up to +200 °C
- **Certification** : at no extra charges this product can be supplied with a works certificate, material certificate, manufacturer test certificate and/or EC Declaration of Conformity. All shackles starting from 150 tons are supplied with a Lloyd's Register of Shipping Certificate on proof load

working load limit	diameter bow	diameter pin	diameter eye	width eye	width inside	length inside	width bow	length	length bolt	width	thickness nut	weight each
t	a	b	c	d	e	f	g	h	i	j	k	kg
	mm	mm	mm	mm	mm	mm	mm	mm	mm	mm	mm	
120	95	95	208	91	147	399	238	646	440	428	50	110
150	105	108	238	102	169	410	275	688	490	485	60	160
200	120	130	279	112	179	512	290	837	520	530	60	235
250	130	140	299	118	205	554	305	904	560	565	65	285
300	140	150	325	123	205	618	305	996	575	585	70	340
400	170	175	376	164	231	668	325	1114	690	665	70	560
500	180	185	398	164	256	718	350	1190	720	710	70	685
600	200	205	444	189	282	718	375	1243	810	775	70	880
700	210	215	454	204	308	718	400	1263	870	820	70	980
800	210	220	464	204	308	718	400	1270	870	820	70	1100
900	220	230	485	215	328	718	420	1296	920	860	70	1280
1000	240	240	515	215	349	718	420	1336	940	900	70	1460
1250	260	270	585	230	369	768	450	1456	1025	970	70	1990
1500	280	290	625	230	369	818	450	1556	1025	1010	70	2400

In inch

working load limit	diameter bow	diameter pin	diameter eye	width eye	width inside	length inside	width bow	length	length bolt	width	thickness nut	weight each
t	a	b	c	d	e	f	g	h	i	j	k	lbs
	inch	inch	inch	inch	inch	inch	inch	inch	inch	inch	inch	
120	3 3/4	3 3/4	8 3/16	3 19/32	5 25/32	15 3/4	9 3/8	25 15/32	17 5/16	16 27/32	1 31/32	243
150	4 1/8	4 1/4	9 3/8	4 1/32	6 21/32	16 5/32	10 13/16	27 3/32	19 9/32	19 3/32	2 3/8	353
200	4 23/32	5 1/8	10 31/32	4 7/16	7 1/16	20 3/16	11 13/32	33	20 15/32	20 7/8	2 3/8	518
250	5 1/8	5 1/2	11 25/32	4 21/32	8 1/16	21 13/16	12	35 19/32	22 1/16	22 1/4	2 9/16	628
300	5 1/2	5 29/32	12 25/32	4 27/32	8 1/16	24 11/32	12	39 7/32	22 5/8	23 1/32	2 3/4	750
400	6 11/16	6 7/8	14 13/16	6 15/32	9 3/32	26 5/16	12 25/32	43 27/32	27 5/32	26 3/16	2 3/4	1235
500	7 3/32	7 9/32	15 21/32	6 15/32	10 3/32	28 9/32	13 25/32	46 27/32	28 11/32	27 15/16	2 3/4	1510
600	7 7/8	8 1/16	17 15/32	7 7/16	11 3/32	28 9/32	14 3/4	48 15/16	31 7/8	30 1/2	2 3/4	1940
700	8 9/32	8 15/32	17 7/8	8 1/32	12 1/8	28 9/32	15 3/4	49 23/32	34 1/4	32 9/32	2 3/4	2161
800	8 9/32	8 21/32	18 9/32	8 1/32	12 1/8	28 9/32	15 3/4	50	34 1/4	32 9/32	2 3/4	2425
900	8 21/32	9 1/16	19 3/32	8 15/32	12 29/32	28 9/32	16 17/32	51 1/32	36 7/32	33 27/32	2 3/4	2822
1000	9 7/16	9 7/16	20 9/32	8 15/32	13 3/4	28 9/32	16 17/32	52 19/32	37	35 7/16	2 3/4	3219
1250	10 1/4	10 5/8	23 1/32	9 1/16	14 17/32	30 1/4	17 23/32	57 5/16	40 11/32	38 3/16	2 3/4	4387
1500	11 1/32	11 13/32	24 19/32	9 1/16	14 17/32	32 7/32	17 23/32	61 1/4	40 11/32	39 3/4	2 3/4	5291

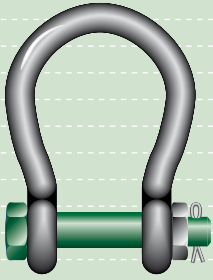

G-4263

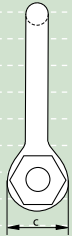
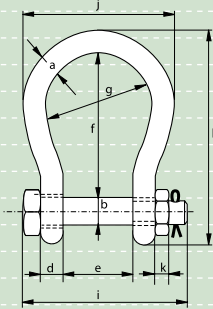

Green Pin® Wide Mouth Shackles

bow shackles with safety bolt

- **Material** : bow and pin alloy steel, Grade 8, quenched and tempered
- **Safety Factor** : MBL equals 6 x WLL
- **Finish** : hot dipped galvanized
- **Temperature Range** : -20 °C up to +200 °C
- **Certification** : at no extra charges this product can be supplied with a works certificate, material certificate, manufacturer test certificate and/or EC Declaration of Conformity

working load limit	diameter bow	diameter pin	diameter eye	width eye	width inside	length inside	width bow	length bow	length bolt	width	thickness nut	weight each
t	a	b	c	d	e	f	g	h	i	j	k	kg
4.75	22	25	52	22	63	112	88	173	157	132	23	2.08
6.5	25	28	59	25	75	135	105	204	182	155	25	3.14
8.5	28	32	66	28	82	148	115	225	201	171	28	4.36
9.5	32	35	72	32	90	162	126	248	217	190	31	5.95
12	35	38	79	35	100	180	140	274	240	210	34	7.87
16	38	42	88	38	106	216	159	319	248	235	19	12.5
25	45	50	103	45	127	248	175	370	296	265	24	18
30	50	57	118	50	146	273	207	411	338	307	27	25
55	65	70	145	65	165	314	213	487	389	343	33	48
75	75	83	166	75	184	330	254	530	432	404	40	70

In inch

working load limit	diameter bow	diameter pin	diameter eye	width eye	width inside	length inside	width bow	length bow	length bolt	width	thickness nut	weight each
t	a	b	c	d	e	f	g	h	i	j	k	lbs
4.75	7/8	1	2 1/16	7/8	2 15/32	4 13/32	3 15/32	6 13/16	6 3/16	5 3/16	29/32	4.59
6.5	1	1 1/8	2 5/16	31/32	2 15/16	5 5/16	4 1/8	8 1/32	7 5/32	6 3/32	31/32	6.92
8.5	1 1/8	1 1/4	2 19/32	1 3/32	3 7/32	5 13/16	4 17/32	8 27/32	7 29/32	6 23/32	1 3/32	9.61
9.5	1 1/4	1 3/8	2 27/32	1 1/4	3 17/32	6 3/8	4 31/32	9 3/4	8 17/32	7 15/32	1 7/32	13.12
12	1 3/8	1 1/2	3 1/8	1 3/8	3 15/16	7 3/32	5 1/2	10 25/32	9 7/16	8 9/32	1 11/32	17.35
16	1 1/2	1 5/8	3 15/32	1 1/2	4 3/16	8 1/2	6 1/4	12 9/16	9 3/4	9 1/4	3/4	27.56
25	1 3/4	2	4 1/16	1 25/32	5	9 3/4	6 7/8	14 9/16	11 21/32	10 7/16	15/16	39.68
30	2	2 1/4	4 21/32	1 31/32	5 3/4	10 3/4	8 5/32	16 3/16	13 5/16	12 3/32	1 1/16	55.12
55	2 1/2	2 3/4	5 23/32	2 9/16	6 1/2	12 3/8	8 3/8	19 3/16	15 5/16	13 1/2	1 5/16	105.82
75	3	3 1/4	6 17/32	2 15/16	7 1/4	13	10	20 7/8	17	15 29/32	1 9/16	154.32



- 1
- 2
- 3
- 4
- 5
- 6
- 7
- 8
- 9
- 10
- 11
- 12
- 13
- 14
- 15
- 16

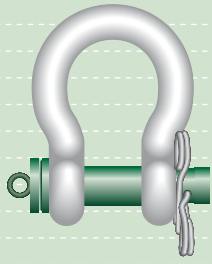

P-5363

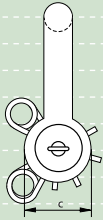
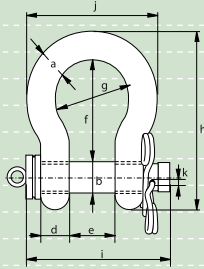

Green Pin® ROV Release Polar Shackles with spring pins

- **Material** : bow and pin alloy steel, Grade 8, quenched and tempered
- **Finish** : body white painted, pin green painted
- **Temperature Range**: -40°C up to +200°C
- **Certificates** : at no extra charges this product can be supplied with a works certificate, material certificate, manufacturer test certificate and/or EC Declaration of Conformity.
- **Note** : for in-line use only
it is up to the user to attach the safety pins with wire ropes etc. and attaching loops or monkey's fists. Van Beest supplies the shackle body, the shackle pin and 2 spring pins.

working load limit	diameter bow	diameter pin	diameter eye	width eye	width inside	length inside	width bow	length bow	length bolt	width bolt	diameter bolt	weight each
t	a	b	c	d	e	f	g	h	i	j	k	kg
17	38	42	88	38	60	146	99	249	202	175	6.5	8.19
25	45	50	103	45	74	178	126	300	249	216	8.5	14.22
55	65	70	145	65	105	260	180	433	330	310	8.5	39.59
85	75	83	162	73	127	329	190	527	380	340	8.5	62



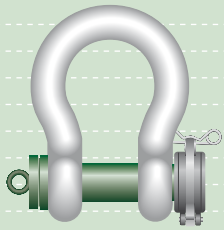

P-5365

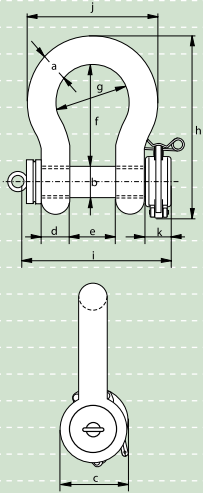

Green Pin® ROV Release Polar Shackles with locking clamp

- **Material** : bow and pin alloy steel, Grade 8, quenched and tempered
- **Safety Factor** : MBL equals 8x WLL for shackles with WLL 17 t and 25 t, MBL equals 6x WLL for shackles with WLL 55 t and 85 t
- **Finish** : body white painted, pin green painted
- **Temperature Range**: -40°C up to +200°C
- **Certificates** : at no extra charges this product can be supplied with a works certificate, material certificate, manufacturer test certificate and/or EC Declaration of Conformity.
- **Note** : it is up to the user to attach the locking clamp with wire ropes etc. and attaching loops or monkey's fists. Van Beest supplies the shackle body, the shackle pin and locking clamp with spring pin.

working load limit	diameter bow	diameter pin	diameter eye	width eye	width inside	length inside	width bow	length bow	length bolt	width locking clamp	width locking clamp	weight each
t	a	b	c	d	e	f	g	h	i	j	k	kg
17	38	42	88	38	60	146	99	250	217	175	48	8.19
25	45	50	103	45	74	178	126	300	250	216	48	14.22
55	65	70	145	65	105	260	180	433	330	310	48	39.59
85	75	83	162	73	127	329	190	527	380	340	48	62



1

2

3

4

5

6

7

8

9

10

11

12

13

14

15

16

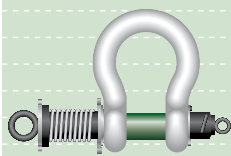

P-5367

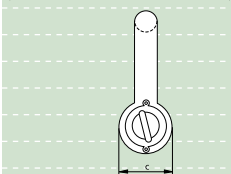
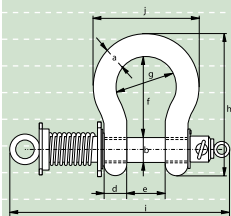

Green Pin® ROV Spring Release Polar Shackles spring loaded

- **Material** : bow and pin alloy steel, Grade 8, quenched and tempered
- **Finish** : body white painted, pin green painted
- **Temperature Range**: -40°C up to +200°C
- **Certificates** : at no extra charges this product can be supplied with a works certificate, material certificate, manufacturer test certificate and/or EC Declaration of Conformity.
- **Note** : for in-line use only
this shackle is assembled with rope slings and monkey's fist for size starting from WLL 42.5 up to and including 150T a special mounting tool (tensioner) is required to assemble the shackle

working load limit	diameter bow	diameter pin	diameter eye	width eye	width inside	length inside	width bow	length	length bolt	width	weight each
t	a	b	c	d	e	f	g	h	i	j	kg
12	32	35	72	32	51	115	83	201	262	147	6
13.5	35	38	80	35	57	133	92	227	275	162	7
17	38	42	88	38	60	146	99	249	330	175	14
25	45	50	103	45	74	178	126	300	352	216	16
35	50	57	116	50	83	197	138	334	373	238	21
42.5	57	65	130	57	95	222	160	377	442	274	32
55	65	70	145	65	105	260	180	433	470	310	43
85	75	83	162	73	127	329	190	527	579	340	71
120	95	95	208	91	147	399	238	646	674	428	131
150	105	108	238	102	169	410	275	688	699	485	171

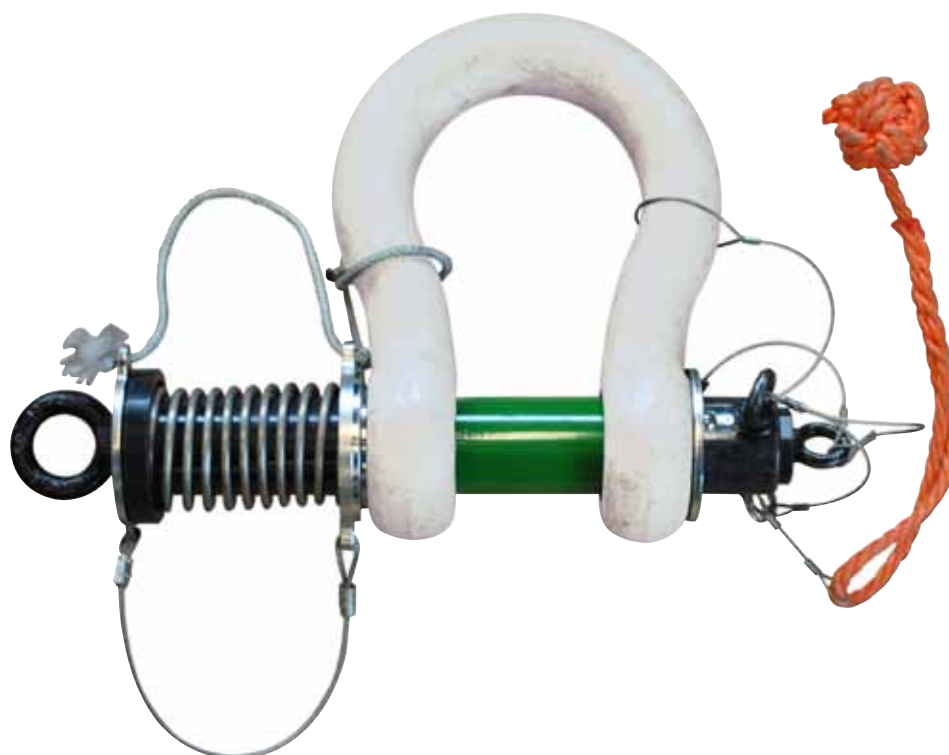



1

2

3

4

5

6

7

8

9

10

11

12

13

14

15

16



G-4164

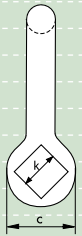
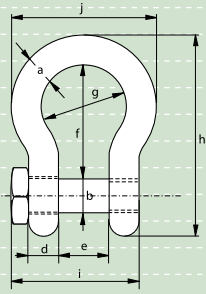

Green Pin® Trawling Shackles

bow shackles with square headed screw pin

- **Material** : bow and pin high tensile steel, Grade 6, quenched and tempered
- **Safety Factor** : MBL equals 6 x WLL
- **Standard** : meets performance requirements of US Fed. Spec. RR-C-271, Grade A
- **Finish** : hot dipped galvanized
- **Certification** : at no extra charges this product can be supplied with a works certificate, material certificate, manufacturer test certificate and/or EC Declaration of Conformity

working load limit	diameter bow	diameter pin	diameter eye	width eye	width inside	length inside	width bow	length bow	length bolt	width bolt head	width bolt head	weight each
t	a	b	c	d	e	f	g	h	i	j	k	kg
2	13.5	16	34	13	22	51	32	89	57.5	58	22	0.34
3.25	16	19	40	16	27	64	43	110	71	75	27	0.63
4.75	19	22	46	19	31	76	51	129	82	89	32	1
6.5	22	25	52	22	36	83	58	144	93	102	32	1.44
8.5	25	28	59	25	43	95	68	164	108	118	36	2.21
9.5	28	32	66	28	47	108	75	185	120	131	41	3.18
12	32	35	72	32	51	115	83	201	137	147	50	4.32
13.5	35	40	80	35	57	133	92	227	149	162	50	5.67
17	38	42	88	38	60	146	99	249	164	175	60	7.36
25	45	50	103	45	74	178	126	300	192	216	60	12.38

In inch

working load limit	diameter bow	diameter pin	diameter eye	width eye	width inside	length inside	width bow	length bow	length bolt	width bolt head	width bolt head	weight each
t	a	b	c	d	e	f	g	h	i	j	k	lbs
2	1/2	5/8	1 11/32	1/2	7/8	2	1 1/4	3 1/2	2 1/4	2 9/32	7/8	0.75
3.25	5/8	3/4	1 9/16	5/8	1 1/16	2 17/32	1 11/16	4 11/32	2 25/32	2 15/16	1 1/16	1.39
4.75	3/4	7/8	1 13/16	3/4	1 7/32	3	2	5 3/32	3 7/32	3 1/2	1 1/4	2.21
6.5	7/8	1	2 1/16	7/8	1 13/32	3 9/32	2 9/32	5 21/32	3 21/32	4 1/32	1 1/4	3.17
8.5	1	1 1/8	2 5/16	31/32	1 11/16	3 3/4	2 11/16	6 15/32	4 1/4	4 21/32	1 13/32	4.86
9.5	1 1/8	1 1/4	2 19/32	1 3/32	1 27/32	4 1/4	2 15/16	7 9/32	4 23/32	5 5/32	1 5/8	7.01
12	1 1/4	1 3/8	2 27/32	1 1/4	2	4 17/32	3 9/32	7 29/32	5 13/32	5 25/32	1 31/32	9.52
13.5	1 3/8	1 1/2	3 5/32	1 3/8	2 1/4	5 1/4	3 5/8	8 15/16	5 7/8	6 3/8	1 31/32	12.49
17	1 1/2	1 5/8	3 15/32	1 1/2	2 3/8	5 3/4	3 29/32	9 13/16	6 15/32	6 7/8	2 3/8	16.23
25	1 3/4	2	4 1/16	1 25/32	2 29/32	7	4 31/32	11 13/26	7 9/16	8 1/2	2 3/8	27.29

Green Pin® Trawling Shackles

dee shackles with square headed screw pin



G-4154

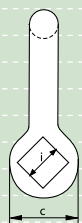
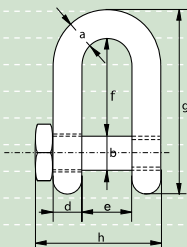

- **Material** : bow and pin high tensile steel, Grade 6, quenched and tempered
- **Safety Factor** : MBL equals 6 x WLL
- **Standard** : meets performance requirements of US Fed. Spec. RR-C-271, Grade A
- **Finish** : hot dipped galvanized
- **Certification** : at no extra charges this product can be supplied with a works certificate, material certificate, manufacturer test certificate and/or EC Declaration of Conformity

working load limit	diameter bow	diameter pin	diameter eye	width eye	width inside	length inside	length	length bolt	width bolt head	weight each
t	a	b	c	d	e	f	g	h	i	kg
2	13.5	16	34	13	22	43	81	57.5	22	0.32
3.25	16	19	40	16	27	51	97	71	27	0.58
4.75	19	22	46	19	31	59	112	82	32	0.92
6.5	22	25	52	22	36	73	134	93	32	1.33
8.5	25	28	59	25	43	85	154	108	36	2.03
9.5	28	32	66	28	47	90	167	120	41	2.88
12	32	35	72	32	51	94	180	137	50	3.96
13.5	35	38	80	35	57	115	209	149	50	5.24
17	38	42	88	38	60	127	230	164	60	6.8
25	45	50	103	45	74	149	271	192	60	11.22

In inch

working load limit	diameter bow	diameter pin	diameter eye	width eye	width inside	length inside	length	length bolt	width bolt head	weight each
t	a	b	c	d	e	f	g	h	i	lbs
2	1/2	5/8	1 11/32	1/2	7/8	1 11/16	3 3/16	2 1/4	7/8	0.7
3.25	5/8	3/4	1 9/16	5/8	1 1/16	2	3 13/16	2 25/32	1 1/16	1.28
4.75	3/4	7/8	1 13/16	3/4	1 7/32	2 5/16	4 13/32	3 7/32	1 1/4	2.03
6.5	7/8	1	2 1/16	7/8	1 13/32	2 7/8	5 9/32	3 21/32	1 1/4	2.93
8.5	1	1 1/8	2 5/16	31/32	1 11/16	3 11/32	6 1/16	4 1/4	1 13/32	4.48
9.5	1 1/8	1 1/4	2 19/32	1 3/32	1 27/32	3 17/32	6 9/16	4 23/32	1 5/8	6.35
12	1 1/4	1 3/8	2 27/32	1 1/4	2	3 11/16	7 3/32	5 13/32	1 31/32	8.72
13.5	1 3/8	1 1/2	3 5/32	1 3/8	2 1/4	4 17/32	8 7/32	5 7/8	1 31/32	11.56
17	1 1/2	1 5/8	3 15/32	1 1/2	2 3/8	5	9 1/16	6 15/32	2 3/8	15
25	1 3/4	2	4 1/16	1 25/32	2 29/32	5 7/8	10 21/32	7 9/16	2 3/8	24.74



G-4169

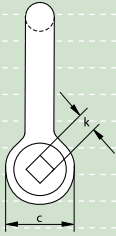
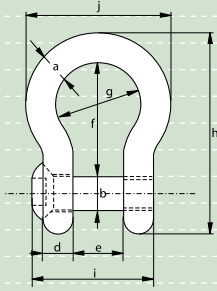

Green Pin® Sunken Hole Shackles

bow shackles with square sunken hole screw pin

- **Material** : bow and pin high tensile steel, Grade 6, quenched and tempered
- **Safety Factor** : MBL equals 6 x WLL
- **Standard** : meets performance requirements of US Fed. Spec. RR-C-271, Grade A
- **Finish** : hot dipped galvanized
- **Certification** : at no extra charges this product can be supplied with a works certificate, material certificate, manufacturer test certificate and/or EC Declaration of Conformity
- **Note** : key for unscrewing the pin must be ordered separately

working load limit	diameter bow	diameter pin	diameter eye	width eye	width inside	length inside	width bow	length bow	length bolt	width hole	size hole	weight each
t	a mm	b mm	c mm	d mm	e mm	f mm	g mm	h mm	i mm	j mm	k mm	kg
2	13.5	16	34	13	22	51	32	89	51	58	11	0.31
3.25	16	19	40	16	27	64	43	110	63	75	11	0.56
4.75	19	22	46	19	31	76	51	129	74	89	11	0.98
6.5	22	25	52	22	36	83	58	144	85	102	13	1.46
8.5	25	28	59	25	43	95	68	164	99	118	13	2.18
9.5	28	32	66	28	47	108	75	185	110	131	17	3.06
12	32	35	72	32	51	115	83	201	122	147	17	4.24
13.5	35	38	80	35	57	133	92	227	135	162	17	5.59
17	38	42	88	38	60	146	99	249	145	175	17	7.37

In inch

working load limit	diameter bow	diameter pin	diameter eye	width eye	width inside	length inside	width bow	length bow	length bolt	width hole	size hole	weight each
t	a inch	b inch	c inch	d inch	e inch	f inch	g inch	h inch	i inch	j inch	k inch	lbs
2	1/2	5/8	1 11/32	1/2	7/8	2	1 1/4	3 1/2	2	2 9/32	7/16	0.68
3.25	5/8	3/4	1 9/16	5/8	1 1/16	2 17/32	1 11/16	4 11/32	2 15/32	2 15/16	7/16	1.23
4.75	3/4	7/8	1 13/16	3/4	1 7/32	3	2	5 3/32	2 29/32	3 1/2	7/16	2.16
6.5	7/8	1	2 1/16	7/8	1 13/32	3 9/32	2 9/32	5 21/32	3 11/32	4 1/32	1/2	3.22
8.5	1	1 1/8	2 5/16	31/32	1 11/16	3 3/4	2 11/16	6 15/32	3 29/32	4 21/32	1/2	4.81
9.5	1 1/8	1 1/4	2 19/32	1 3/32	1 27/32	4 1/4	2 15/16	7 9/32	4 11/32	5 5/32	21/32	6.75
12	1 1/4	1 3/8	2 27/32	1 1/4	2	4 17/32	3 9/32	7 29/32	4 13/16	5 25/32	21/32	9.35
13.5	1 3/8	1 1/2	3 5/32	1 3/8	2 1/4	5 1/4	3 5/8	8 15/16	5 5/16	6 3/8	21/32	12.32
17	1 1/2	1 5/8	3 15/32	1 1/2	2 3/8	5 3/4	3 29/32	9 13/16	5 23/32	6 7/8	21/32	16.25



P-4170





G-4159

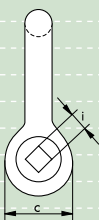
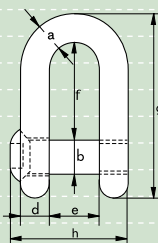

Green Pin® Sunken Hole Shackles

dee shackles with square sunken hole screw pin

- **Material** : bow and pin high tensile steel, Grade 6, quenched and tempered
- **Safety Factor** : MBL equals 6 x WLL
- **Standard** : meets performance requirements of US Fed. Spec. RR-C-271, Grade A
- **Finish** : hot dipped galvanized
- **Certification** : at no extra charges this product can be supplied with a works certificate, material certificate, manufacturer test certificate and/or EC Declaration of Conformity
- **Note** : key for unscrewing the pin must be ordered separately

working load limit	diameter bow	diameter pin	diameter eye	width eye	width inside	length inside	length inside	length bolt	size hole	weight each
t	a	b	c	d	e	f	g	h	i	kg
2	13.5	16	34	13	22	43	81	51	11	0.34
3.25	16	19	40	16	27	51	97	63	11	0.6
4.75	19	22	46	19	31	59	112	74	11	0.98
6.5	22	25	52	22	36	73	134	85	13	1.26
8.5	25	28	59	25	43	85	154	99	13	2.14
9.5	28	32	66	28	47	90	167	110	17	3.05
12	32	35	72	32	51	94	180	122	17	3.56
13.5	35	38	80	35	57	115	209	135	17	5.17
17	38	42	88	38	60	127	230	145	17	6.84

In inch

working load limit	diameter bow	diameter pin	diameter eye	width eye	width inside	length inside	length inside	length bolt	size hole	weight each
t	a	b	c	d	e	f	g	h	i	lbs
2	1/2	5/8	1 11/32	1/2	7/8	1 11/16	3 3/16	2	7/16	0.75
3.25	5/8	3/4	1 9/16	5/8	1 1/16	2	3 13/16	2 15/32	7/16	1.33
4.75	3/4	7/8	1 13/16	3/4	1 7/32	2 5/16	4 13/32	2 29/32	7/16	2.15
6.5	7/8	1	2 1/16	7/8	1 13/32	2 7/8	5 9/32	3 11/32	1/2	2.77
8.5	1	1 1/8	2 5/16	31/32	1 11/16	3 11/32	6 1/16	3 29/32	1/2	4.72
9.5	1 1/8	1 1/4	2 19/32	1 3/32	1 27/32	3 17/32	6 9/16	4 11/32	21/32	6.72
12	1 1/4	1 3/8	2 27/32	1 1/4	2	3 11/16	7 3/32	4 13/16	21/32	7.84
13.5	1 3/8	1 1/2	3 5/32	1 3/8	2 1/4	4 17/32	8 7/32	5 5/16	21/32	11.4
17	1 1/2	1 5/8	3 15/32	1 1/2	2 3/8	5	9 1/16	5 23/32	21/32	15.08



P-4170

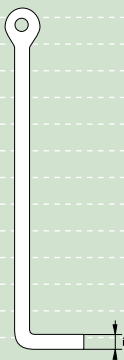

1

2

3

4

5

6

7

8

9

10

11

12

13

14

15

16

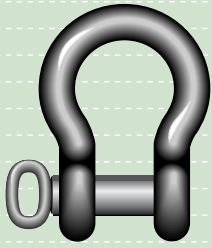

S-1165

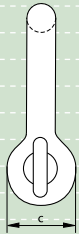
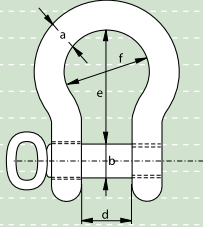

Mooring Shackles

bow shackles with screw pin

- **Material** : mild steel, untreated, Grade 3
- **Finish** : self coloured
- **Note** : not to be used for lifting applications

diameter bow	diameter pin	diameter eye	width inside	length inside	width bow	weight each
a	b	c	d	e	f	kg
mm	mm	mm	mm	mm	mm	
32	32	74	64	134	96	4.2
38	38	89	76	160	114	7.8
45	45	104	90	189	135	12.5
50	50	111	100	210	155	17.4
65	65	145	130	273	195	35.6

1

2

3

4

5

6

7

8

9

10

11

12

13

14

15

16

Shackles generally to DIN 82016 type B bow shackles with safety bolt

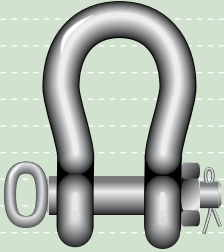
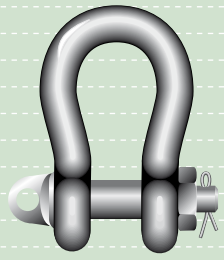

S-3466
G-3466

- **Material** : bow and pin high tensile steel, Grade 4
- **Safety Factor** : MBL equals 4 x WLL
- **Standard** : generally to DIN 82016 type B
- **Finish** : hot dipped galvanized or self coloured
- **Certification** : at no extra charges this product can be supplied with a works certificate.
- **Note** : with screw collar pin : up to size no. 25
: with hand-grip : from size no. 32

no.	working load limit	thickness bow	thickness bow	diameter pin	diameter eye	width inside	length inside	width bow	weight each
	t	a	b	c	d	e	f	g	kg
		mm	mm	mm	mm	mm	mm	mm	
8	8	54	38	45	90	60	152	93	9.3
10	10	60	42	48	96	66	166	102	12
12	12	67	47	52	104	73	184	114	15.7
16	16	76	52	60	120	81	210	128	21
20	20	85	58	68	136	90	231	140	31.4
25	25	92	63	72	144	100	254	155	39.4
32	32	100	70	80	160	110	285	175	53.3
40	40	107	79	90	180	125	315	195	75.3
50	50	120	88	100	200	140	360	220	105
63	63	135	96	110	220	155	395	245	137
80	80	150	110	125	250	175	447	275	200
100	100	165	125	140	280	200	500	305	300

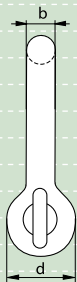
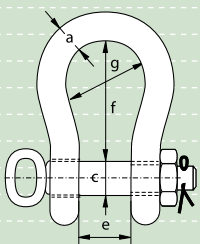
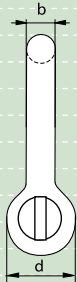
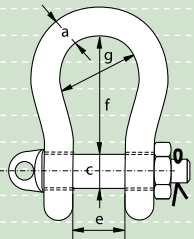

- 1
- 2
- 3
- 4
- 5
- 6
- 7
- 8
- 9
- 10
- 11
- 12
- 13
- 14
- 15
- 16



S-3351
G-3351

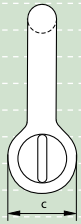
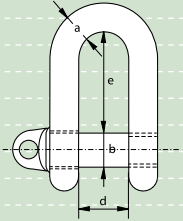

Shackles generally to DIN 82101 type A dee shackles with screw collar pin

- **Material** : bow and pin high tensile steel, Grade 4
- **Safety Factor** : MBL equals 5 x WLL
- **Standard** : generally to DIN 82101 type A
- **Finish** : hot dipped galvanized or self coloured
- **Certification** : at no extra charges this product can be supplied with a works certificate.
- **Note** : shackle no. 0.1 is electro-galvanized and will not have any markings as it is too small

no.	working load limit	diameter bow	diameter pin	diameter eye	width inside	length inside	weight each
	t	a mm	b mm	c mm	d mm	e mm	kg
0.1	0.1	5	5	10	7	15.5	0.017
0.16	0.16	6	6	12	8	18	0.024
0.25	0.25	8	8	16	11	24	0.054
0.4	0.4	10	10	20	14	30	0.097
0.6	0.63	12	12	24	17	36	0.18
1	1	13	16	32	21	49	0.3
1.6	1.6	16	20	40	27	61	0.57
2	2	20	22	44	30	67	0.975
2.5	2.5	22	24	48	33	73	1.3
3	3.15	25	27	54	38	83.5	1.85
4	4	28	30	60	42	91	2.53
5	5	32	36	72	47	111	4
6	6.3	36	39	78	53	119.5	5.3
8	8	41	45	90	60	139.5	7.9
10	10	44	48	96	66	147	10
12	12	49	52	104	73	158	13.5
16	16	55	60	120	81	185	19.2
20	20	61	68	136	90	211	28
25	25	67	72	144	100	221	34

Shackles generally to DIN 82101 type B dee shackles with counter sunk screw pin

- **Material** : bow and pin high tensile steel, Grade 4
- **Safety Factor** : MBL equals 5 x WLL
- **Standard** : generally to DIN 82101 type B
- **Finish** : hot dipped galvanized or self coloured
- **Certification** : at no extra charges this product can be supplied with a works certificate.
- **Note** : shackle no. 0.1 is electro-galvanized and will not have any markings as it is too small

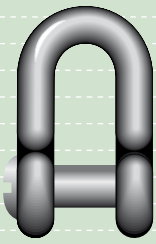

S-3352
G-3352

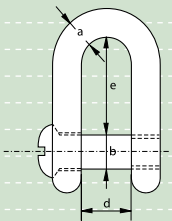

no.	working load limit	diameter bow	diameter pin	diameter eye	width inside	length inside	weight each
	t	a mm	b mm	c mm	d mm	e mm	kg
0.1	0.1	5	5	10	7	15.5	0.014
0.16	0.16	6	6	12	8	18	0.023
0.25	0.25	8	8	16	11	24	0.052
0.4	0.4	10	10	20	14	30	0.093
0.6	0.63	12	12	24	17	36	0.173
1	1	13	16	32	21	49	0.29
1.6	1.6	16	20	40	27	61	0.543
2	2	20	22	44	30	67	0.95
2.5	2.5	22	24	48	33	73	1.23
3	3.15	25	27	54	38	83.5	1.8
4	4	28	30	60	42	91	2.6
5	5	32	36	72	47	111	3.8
6	6.3	36	39	78	53	119.5	5.2
8	8	41	45	90	60	139.5	7.6
10	10	44	48	96	66	147	9.7

Shackles generally to DIN 82101 type C

dee shackles with safety bolt

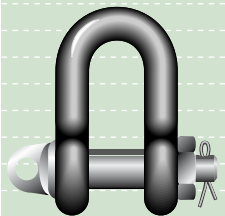

- **Material** : bow and pin high tensile steel, Grade 4
- **Safety Factor** : MBL equals 5 x WLL
- **Standard** : generally to DIN 82101 type C
- **Finish** : hot dipped galvanized or self coloured
- **Certification** : at no extra charges this product can be supplied with a works certificate.
- **Note** : with screw collar pin : up to size no. 25
with hand-grip : from size no. 32

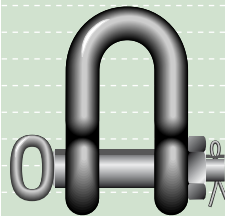

S-3356
G-3356

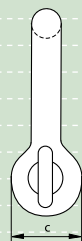
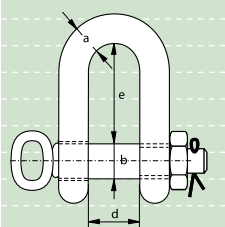
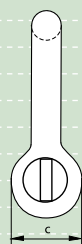
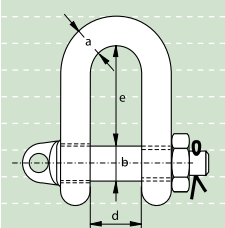

no.	working load limit	diameter bow	diameter pin	diameter eye	width inside	length inside	weight each
		a mm	b mm	c mm	d mm	e mm	kg
0.4	0.4	10	10	20	14	30	0.113
0.6	0.63	12	12	24	17	36	0.2
1	1	13	16	32	21	49	0.37
1.6	1.6	16	20	40	27	61	0.686
2	2	20	22	44	30	67	1.125
2.5	2.5	22	24	48	33	73	1.5
3	3.15	25	27	54	38	83.5	2.15
4	4	28	30	60	42	91	2.93
5	5	32	36	72	47	111	4.7
6	6.3	36	39	78	53	119.5	6.33
8	8	41	45	90	60	139.5	8.5
10	10	44	48	96	66	147	10.8
12	12.5	49	52	104	73	158	14.4
16	16	55	60	120	81	185	20.5
20	20	61	68	136	90	211	29.5
25	25	67	72	144	100	221	36
32	32	74	80	160	110	246	49
40	40	75	90	180	125	276	75
50	50	88	100	200	140	307	100
63	63	96	110	220	155	339	140
80	80	110	125	250	175	385.5	200
100	100	125	140	280	200	430	280

1

2

3

4

5

6

7

8

9

10

11

12

13

14

15

16

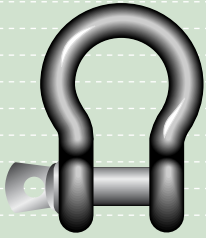

G-3161

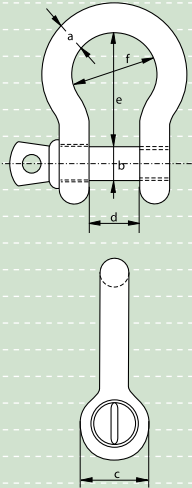

Yellow Pin Shackles

bow shackles with screw collar pin

- **Material** : bow and pin high tensile steel, Grade 6
- **Standard** : generally to US Fed. Spec. RR-C-271
- **Finish** : hot dipped galvanized
- **Note** : import quality

working load limit	diameter bow	diameter pin	diameter eye	width inside	length inside	width bow	weight each
t	a mm	b mm	c mm	d mm	e mm	f mm	kg
0.33	5	6	14	9.5	22	15	0.03
0.5	6	8	16	12	29	20	0.05
0.75	8	10	19	13.5	31	21	0.09
1	10	11	23	17	37	26	0.14
1.5	11	13	27	19	43	29	0.2
2	13	16	30	20	48	33	0.33
3.25	16	19	38	27	60	43	0.62
4.75	19	22	46	32	71	50	1.07
6.5	22	25	53	36	84	58	1.64
8.5	25	28	61	43	95	68	2.28
9.5	28	32	68	46	108	74	3.36
12	32	35	76	51	119	82	4.31
13.5	35	38	84	57	133	92	6.14
17	38	42	92	60	146	98	7.81
25	45	50	106	73	177	127	12.61

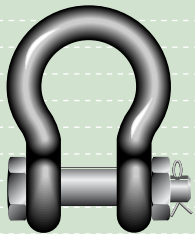

G-3163

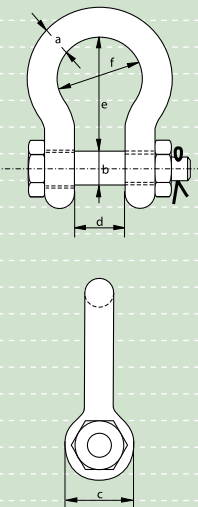

Yellow Pin Shackles

bow shackles with safety bolt

- **Material** : bow and pin high tensile steel, Grade 6
- **Standard** : generally to US Fed. Spec. RR-C-271
- **Finish** : hot dipped galvanized
- **Note** : import quality

working load limit	diameter bow	diameter pin	diameter eye	width inside	length inside	width bow	weight each
t	a mm	b mm	c mm	d mm	e mm	f mm	kg
2	13	16	30	20	48	33	0.36
3.25	16	19	38	27	60	43	0.7
4.75	19	22	46	32	71	50	1.1
6.5	22	25	53	36	84	58	1.79
8.5	25	28	61	43	95	68	2.57
9.5	28	32	68	46	108	74	3.75
12	32	35	76	51	119	82	5.32
13.5	35	38	84	57	133	92	7.19
17	38	42	92	60	146	98	9.44
25	45	50	106	73	177	127	15.4



G-3151

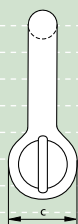
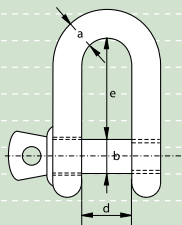

Yellow Pin Shackles

dee shackles with screw collar pin

- **Material** : bow and pin high tensile steel, Grade 6
- **Standard** : generally to US Fed. Spec. RR-C-271
- **Finish** : hot dipped galvanized
- **Note** : import quality

working load limit	diameter bow	diameter pin	diameter eye	width inside	length inside	weight each
t	a mm	b mm	c mm	d mm	e mm	kg
0.33	5	6	12	9.5	19	0.03
0.5	6	8	16	12	22	0.05
0.75	8	10	19	13.5	26	0.08
1	10	11	23	17	32	0.13
1.5	11	13	27	19	37	0.2
2	13	16	30	20	41	0.27
3.25	16	19	38	27	51	0.57
4.75	19	22	46	32	60	1.19
6.5	22	25	53	36	71	1.43
8.5	25	28	61	43	81	2.16
9.5	28	32	68	46	90	3.06
12	32	35	76	51	100	4.11
13.5	35	38	84	57	111	5.28
17	38	42	92	60	122	7.24
25	45	50	106	73	146	12.14

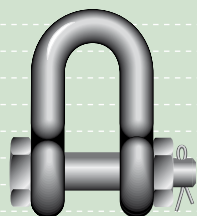

G-3153

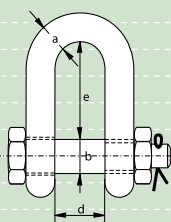

Yellow Pin Shackles

dee shackles with safety bolt

- **Material** : bow and pin high tensile steel, Grade 6
- **Standard** : generally to US Fed. Spec. RR-C-271
- **Finish** : hot dipped galvanized
- **Note** : import quality

working load limit	diameter bow	diameter pin	diameter eye	width inside	length inside	weight each
t	a mm	b mm	c mm	d mm	e mm	kg
2	13	16	30	20	41	0.35
3.25	16	19	38	27	51	0.65
4.75	19	22	46	32	60	1.02
6.5	22	25	53	36	71	1.75
8.5	25	28	61	43	81	2.52
9.5	28	32	68	46	90	3.5
12	32	35	76	51	100	4.91
13.5	35	38	84	57	111	5.84
17	38	42	92	60	122	8.4
25	45	50	106	73	146	11.9

1

2

3

4

5

6

7

8

9

10

11

12

13

14

15

16

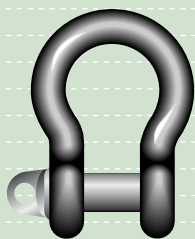

S-2761
E-2761
G-2761

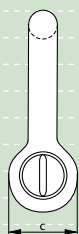
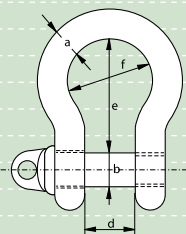

Shackles generally to B.S. 3032 table 3 large bow shackles with screw collar pin

- **Material** : bow and pin alloy steel, EN14a
- **Safety Factor** : MBL equals 4 x WLL
- **Standard** : generally to B.S. 3032 table 3
- **Finish** : hot dipped galvanized, electro-galvanized or self coloured
- **Certification** : at no extra charges this product can be supplied with a works certificate

working load limit	diameter bow	diameter pin	diameter eye	width inside	length inside	width bow	weight each
t	a mm	b mm	c mm	d mm	e mm	f mm	kg
0.15	6	10	19	13	28	19	0.12
0.45	10	13	25	16	41	25	0.18
0.75	13	16	32	22	54	32	0.37
1.25	16	19	38	28	70	41	0.72
2	19	22	44	35	86	51	1.20
2.75	22	25	51	41	98	57	1.85
3.75	25	28	57	44	108	64	2.61
4.75	28	32	63	51	124	73	3.78
5.75	32	35	70	57	137	83	5.17
7.25	35	38	76	63	152	89	6.46
8.5	38	44	89	70	168	98	8.34
9.5	42	48	94	76	187	111	11.1
11.5	44	51	102	86	206	121	14.5
13	48	54	108	92	222	130	17.8
15	51	57	114	98	238	140	25.5
18.5	57	63	127	105	257	152	34.4
20	60	67	133	111	273	162	36.8
25	67	73	146	121	302	178	45
30	73	79	159	133	330	197	62.2
35	79	86	171	146	359	213	81.8
40	86	92	184	159	387	229	95
50	95	102	203	171	429	254	131
65	108	117	235	197	483	286	194
80	117	127	254	216	533	308	274

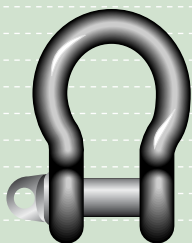

S-2765
E-2765
G-2765

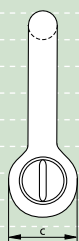
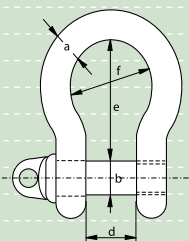

Shackles generally to B.S. 3032 table 4 small bow shackles with screw collar pin

- **Material** : bow and pin alloy steel, EN14a
- **Safety Factor** : MBL equals 4 x WLL
- **Standard** : generally to B.S. 3032 table 4
- **Finish** : hot dipped galvanized, electro-galvanized or self coloured
- **Certification** : at no extra charges this product can be supplied with a works certificate

working load limit	diameter bow	diameter pin	diameter eye	width inside	length inside	width bow	weight each
t	a mm	b mm	c mm	d mm	e mm	f mm	kg
0.2	6	10	19	13	25	16	0.11
0.5	10	13	25	16	38	22	0.17
1	13	16	32	22	51	29	0.35
1.5	16	19	38	28	64	38	0.66
2	19	22	44	35	76	44	1.06
3	22	25	51	38	89	51	1.68
4	25	28	57	44	102	60	2.47
5	28	32	63	51	114	67	3.48
6.25	32	35	70	57	127	76	4.79
7.5	35	38	76	60	140	83	5.95
9.25	38	44	89	67	152	89	7.55
10.5	41	48	95	73	165	98	9.79
12.5	44	51	102	79	178	105	12.5
14.25	48	54	108	86	191	114	15.3
16.5	51	57	114	92	203	121	21.8
18.5	54	60	121	95	216	127	28.9
20	57	63	127	105	229	137	30.9
25	63	70	140	114	254	152	37.8
30	70	79	159	127	279	168	52.6
35	76	86	171	137	305	184	69.5
40	79	89	178	143	318	191	78.1
50	89	98	203	159	356	213	109
65	102	114	229	184	406	244	163
80	114	127	254	206	457	273	235

1

2

3

4

5

6

7

8

9

10

11

12

13

14

15

16



S-2751
E-2751
G-2751

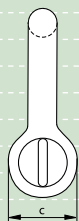
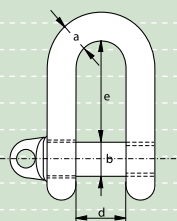

Shackles generally to B.S. 3032 table 2 large dee shackles with screw collar pin

- **Material** : bow and pin alloy steel, EN14a
- **Safety Factor** : MBL equals 4 x WLL
- **Standard** : generally to B.S. 3032 table 2
- **Finish** : hot dipped galvanized, electro-galvanized or self coloured
- **Certification** : at no extra charges this product can be supplied with a works certificate

working load limit	diameter bow	diameter pin	diameter eye	width inside	length inside	weight each
t	a mm	b mm	c mm	d mm	e mm	kg
0.25	6	10	19	13	25	0.11
0.5	10	13	25	19	38	0.17
0.75	13	16	32	28	54	0.35
1.5	16	19	38	32	64	0.66
2	19	22	44	38	73	1.02
3	22	25	51	44	83	1.57
3.75	25	28	57	51	95	2.3
5	28	32	64	54	105	3.2
6	32	35	70	60	114	4.3
7	35	38	76	67	127	5.4
9.5	38	45	83	70	137	6.8
11.25	42	48	89	76	146	8.7
13	44	51	95	83	156	11
14.25	48	54	108	92	178	14.3
16.25	51	57	114	98	187	20
18	54	60	121	105	197	26.4
20	57	64	127	108	210	28.3
25	64	73	146	121	235	35
30	70	79	159	133	260	49
35	76	86	171	146	279	63.6
40	79	89	178	149	292	71.7
50	89	102	203	171	330	101
65	102	114	229	191	375	151
80	114	127	254	219	419	215

1

2

3

4

5

6

7

8

9

10

11

12

13

14

15

16



S-2755
E-2755
G-2755

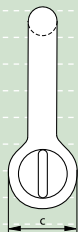
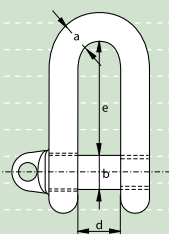

Shackles generally to B.S. 3032 table 1 small dee shackles with screw collar pin

- **Material** : bow and pin alloy steel, EN14a
- **Safety Factor** : MBL equals 4 x WLL
- **Standard** : generally to B.S. 3032 table 1
- **Finish** : hot dipped galvanized, electro-galvanized or self coloured
- **Certification** : at no extra charges this product can be supplied with a works certificate

working load limit	diameter bow	diameter pin	diameter eye	width inside	length inside	weight each
t	a mm	b mm	c mm	d mm	e mm	kg
0.3	6	10	19	9.5	22	0.1
0.6	10	13	25	16	35	0.16
1	13	16	32	22	48	0.31
1.75	16	19	38	25	57	0.59
2.5	19	22	44	32	70	0.98
3.5	22	25	51	35	83	1.55
4.5	25	28	57	38	92	2.2
5.5	28	32	64	44	105	3.1
7	32	35	70	48	114	4.2
8	35	38	83	54	127	5.1
10.75	38	45	89	60	140	6.6
13	42	48	95	64	149	8.1
14.75	44	51	102	70	162	10.5
16.75	48	54	108	73	171	13.3
19	51	57	114	76	184	19.2
20	54	60	121	83	197	22.4
25	60	70	140	92	219	25.3
30	64	73	146	98	229	31.5
35	70	79	159	108	254	47
40	73	83	165	111	264	60.2
50	83	95	190	127	298	68.5
65	92	108	216	140	333	98
80	102	117	235	156	368	147

1

2

3

4

5

6

7

8

9

10

11

12

13

14

15

16



S-1161
E-1161

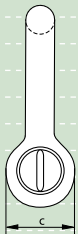
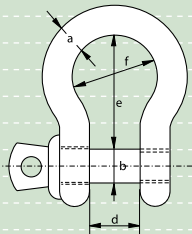

Commercial Shackles

bow shackles with screw collar pin

- **Material** : mild steel, untreated, Grade 3
- **Finish** : electro-galvanized or self coloured
- **Note** : not to be used for lifting applications

diameter bow	diameter pin	diameter eye	width inside	length inside	width bow	weight per 100 pcs
a mm	b mm	c mm	d mm	e mm	f mm	kg
5	5	10	10	20	15	1.54
6	6	12	12	24	18	2.66
8	8	16	16	32	24	6.29
10	10	20	20	40	30	12.3
11	11	22	22	44	33	16.4
12	12	24	24	48	36	21.2
14	14	28	28	56	42	33.7
16	16	32	32	64	48	50.3
19	19	38	38	76	57	98.3
22	22	44	44	88	66	131
25	25	50	50	100	75	192
28	28	56	56	112	84	270
32	32	64	64	128	96	403
38	38	76	76	152	114	674
45	45	90	90	180	135	1120
50	50	100	100	200	150	1536
57	57	114	114	228	171	2276
65	65	130	130	260	195	3375

Commercial Shackles

bow shackles with square head screw pin

- **Material** : mild steel, untreated, Grade 3
- **Finish** : self coloured
- **Note** : not to be used for lifting applications

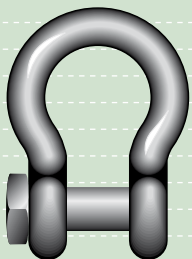

S-1164

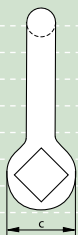
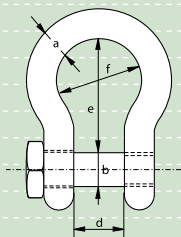

diameter bow	diameter pin	diameter eye	width inside	length inside	width bow	weight per 100 pcs
a mm	b mm	c mm	d mm	e mm	f mm	kg
6	6	12	12	24	18	2.7
8	8	16	16	32	24	6.4
10	10	20	20	40	30	12.5
11	11	22	22	44	33	16.6
12	12	24	24	48	36	21.6
14	14	28	28	56	42	34.3
16	16	32	32	64	48	51.2
19	19	38	38	76	57	100
22	22	44	44	88	66	133
25	25	50	50	100	75	195
28	28	56	56	112	84	275
32	32	64	64	128	96	410
38	38	76	76	152	114	686

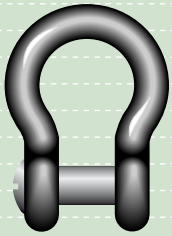

S-1162
E-1162

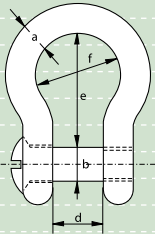

Commercial Shackles

bow shackles with counter sunk screw pin

- **Material** : mild steel, untreated, Grade 3
- **Finish** : electro-galvanized or self coloured
- **Note** : not to be used for lifting applications

diameter bow	diameter pin	diameter eye	width inside	length inside	width bow	weight per 100 pcs
a mm	b mm	c mm	d mm	e mm	f mm	kg
8	8	16	16	32	24	6
10	10	20	20	40	30	11.6
11	11	22	22	44	33	15.5
12	12	24	24	48	36	20.1
14	14	28	28	56	42	31.9
16	16	32	32	64	48	47.6
19	19	38	38	76	57	93.1
22	22	44	44	88	66	124
25	25	50	50	100	75	182

1

2

3

4

5

6

7

8

9

10

11

12

13

14

15

16



S-1151
E-1151

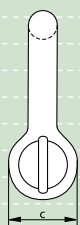
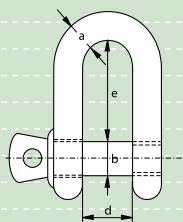

Commercial Shackles

dee shackles with screw collar pin

- **Material** : mild steel, untreated, Grade 3
- **Finish** : electro-galvanized or self coloured
- **Note** : not to be used for lifting applications

diameter bow	diameter pin	diameter eye	width inside	length inside	weight per 100 pcs
a mm	b mm	c mm	d mm	e mm	kg
5	5	10	10	20	1.47
6	6	12	12	24	2.56
8	8	16	16	32	6.06
10	10	20	20	40	11.8
11	11	22	22	44	15.8
12	12	24	24	48	20.5
14	14	28	28	56	32.5
16	16	32	32	64	48.5
19	19	38	38	76	94.7
22	22	44	44	88	126
25	25	50	50	100	185
28	28	56	56	112	260
32	32	64	64	128	388
38	38	76	76	152	650
45	45	90	90	180	1080
50	50	100	100	200	1480
57	57	114	114	228	2192
65	65	130	130	260	3252

Commercial Shackles

dee shackles with square head screw pin

- **Material** : mild steel, untreated, Grade 3
- **Finish** : self coloured
- **Note** : not to be used for lifting applications

diameter bow	diameter pin	diameter eye	width inside	length inside	weight per 100 pcs
a mm	b mm	c mm	d mm	e mm	kg
6	6	12	12	24	2.6
8	8	16	16	32	6.17
10	10	20	20	40	12
11	11	22	22	44	16
12	12	24	24	48	20.8
14	14	28	28	56	33.1
16	16	32	32	64	49.4
19	19	38	38	76	96.4
22	22	44	44	88	128
25	25	50	50	100	188
28	28	56	56	112	265
32	32	64	64	128	395
38	38	76	76	152	661



S-1154

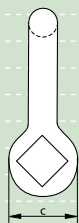
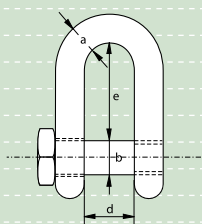

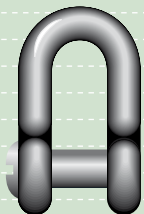

S-1152
E-1152

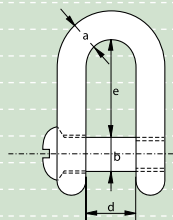

Commercial Shackles

dee shackles with counter sunk screw pin

- **Material** : mild steel, untreated, Grade 3
- **Finish** : electro-galvanized or self coloured
- **Note** : not to be used for lifting applications

diameter bow	diameter pin	diameter eye	width inside	length inside	weight per 100 pcs
a	b	c	d	e	kg
8	8	16	16	32	5.72
10	10	20	20	40	11.2
11	11	22	22	44	14.9
12	12	24	24	48	19.3
14	14	28	28	56	30.7
16	16	32	32	64	45.8
19	19	38	38	76	89.5
22	22	44	44	88	119
25	25	50	50	100	175

Commercial Shackles

danlino V shackles with square head screw pin

- **Material** : mild steel, untreated, Grade 3
- **Finish** : self coloured
- **Note** : not to be used for lifting applications

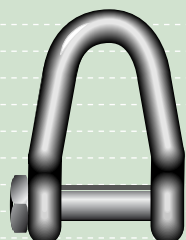

S-1170

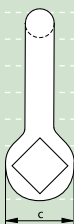
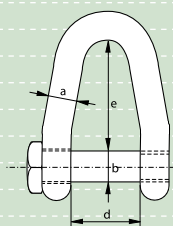

diameter bow	diameter pin	diameter eye	width inside	length inside	weight per 100 pcs
a	b	c	d	e	kg
32	32	64	78	120	470

1

2

3

4

5

6

7

8

9

10

11

12

13

14

15

16